

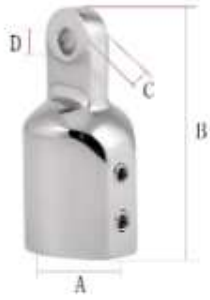

➤ **ACCESSORI PER LA NAUTICA**

AISI316 CAPPUCCIO TERMINALE



Cod.	Dim.	A mm	B mm	C mm
TR4322	7/8' '	22.5	60	7
TR4325	1' '	25.5	60	7

AISI316 CAPPUCCIO TERMINALE RIALZATO



Cod.	Dim.
TR4422	7/8 inch
TR4425	1 inch

AISI316 CAPPUCCIO TERMINALE

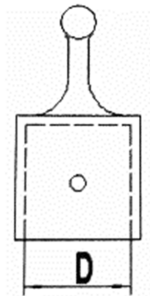

Cod.	D
TR4522	7/8 inch
TR4525	1 inch

AISI316 CAPPUCCIO TERMINALE INTERNO

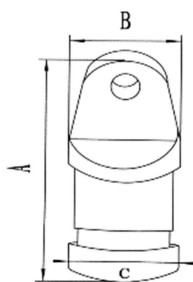

Cod.	A mm	B mm	C mm
TR4619	48	21.3	18.8
TR4622	48	21.6	19.2
TR4625	49	24.7	22.2

AISI316 SNODO A FORCELLA

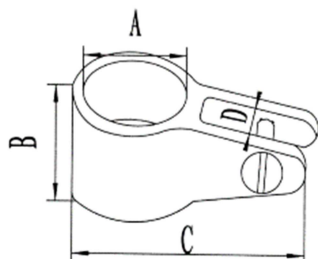

Cod.	Dim.	A mm	B mm	C mm
TR4719	3/4' '	19.5	25	6.5
TR4722	7/8' '	22.6	28	7.8
TR4725	1' '	25.6	28	8
TR4730	1-1/5' '	30.6	27	8
TR4732	1-1/4' '	32.6	27	8

AISI316 SNODO A FORCELLA

Cod.	Dim.	A	B	C	D
TR4822	7/8' '	22.6	57.2	30.2	7.3
TR4825	1' '	25.6	57.5	30.3	7.5

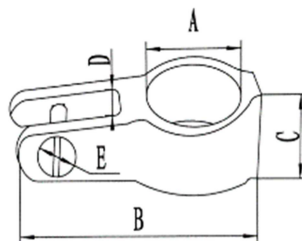

AISI316 SNODO A FORCELLA

Cod.	Dim.	A	B	C	D
TR4922	7/8' '	22.6	60	30	7.5
TR4925	1' '	25.7	62	31	7.6

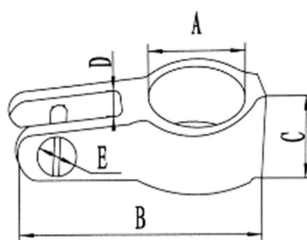

AISI316 ATTACCO PER CAPOTTINA A MANICOTTO

Cod.	Dim.	A mm	B mm	Cmm
TR5022	7/8' '	22.5	57	27
TR5025	1' '	25.5	70	28
TR5030	1-1/5' '	30.5	78	29
TR5032	1-1/4' '	32.5	78	29
TR5038	1-1/2' '	38.6	80	30
TR5050	2' '	50.6	80	30

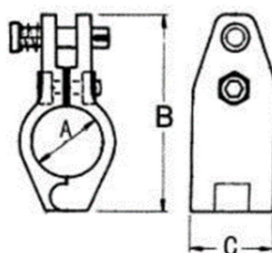

AISI316 ATTACCO PER CAPOTTINA A MANICOTTO, SPINA A MOLLA

Cod.	Dim.	A mm	B mm	C mm
TR5122	7/8' '	22.5	57	27
TR5125	1' '	25.5	70	28
TR5130	1-1/5' '	30.5	78	29
TR5132	1-1/4' '	32.5	78	29

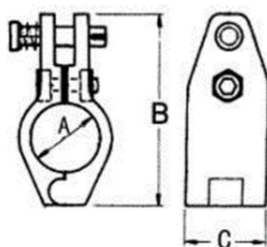

AISI316 ATTACCO PER CAPOTTINA A MANICOTTO

Cod.	Dim.	A mm	B mm	C mm
TR5222	7/8' '	22.5	71	30
TR5225	1' '	25.5	75	31
TR5230	1-1/5' '	30.5	84	32

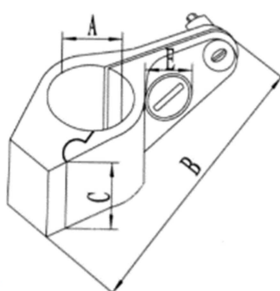

AISI316 ATTACCO PER CAPOTTINA

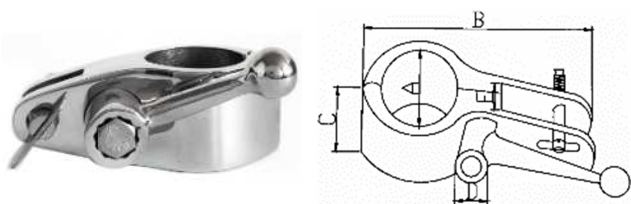

Cod.	Dim.	A	B	C	D
TR5322	7/8' '	22.5	65	23	4.7
TR5325	1' '	25.5	67	25	4.9
TR5330	1-1/5' '	30.5	68	28	4.9

AISI316 SUPPORTO A FORCELLA 90°

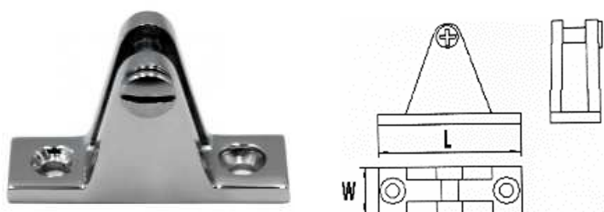

Cod.	L mm	W mm
TR5401	61	18.7

AISI316 SUPPORTO A FORCELLA 90°-REMOVIBILE

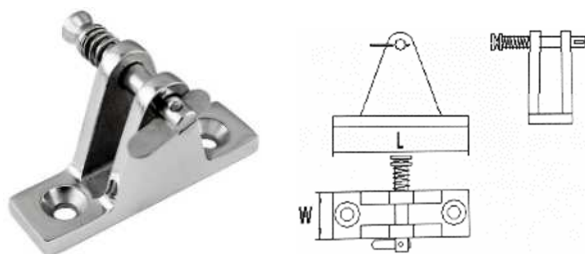

Cod.	L mm	W mm
TR5402	61	18.7

AISI316 SUPPORTO A FORCELLA 90°-REMOVIBILE

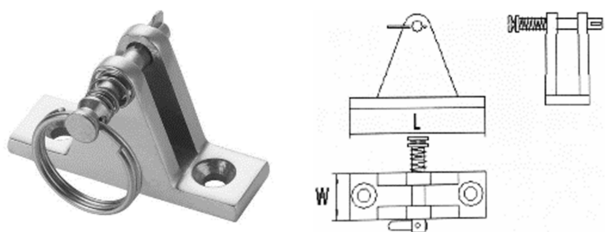

Cod.	L mm	W mm
TR5403	61	18.5

AI316 SUPPORTO A FORCELLA CON BASE CONCAVA

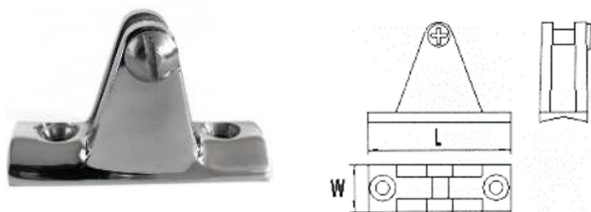

Cod.	L mm	Wmm	X tubo mm
TR5404A	56.5	19.5	22.5
TR5404B	61	21	25.5

AI316 SUPPORTO A FORCELLA CON BASE CONCAVA SPINOTTO REMOVIBILE

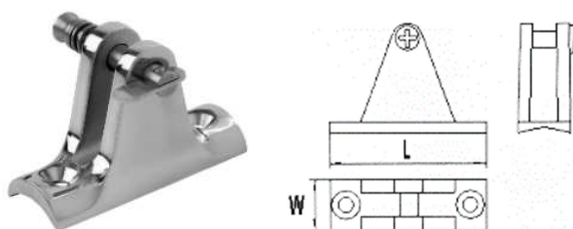

Cod.	L mm	Wmm	X tubo mm
TR5410A	56.5	19.5	22.5
TR5410B	61	21	25.5

AISI316 SUPPORTO A FORCELLA 60°

Cod.	L mm	W mm
TR5411	56	18.5

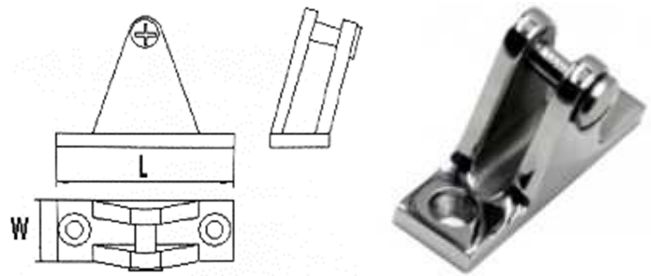

AISI316 SUPPORTO A FORCELLA 60°-SPINOTTO REMOVIBILE

Cod.	L mm	W mm
TR5412	61	18.5

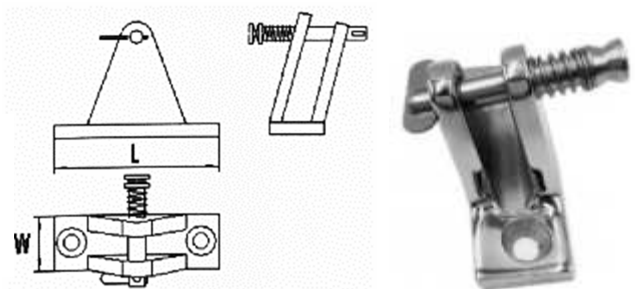

AISI316 SUPPORTO A PARETE 90°

Cod.	A mm	B mm	C mm
TR5413A	50.8	22.3	25
TR5413B	50.8	32.5	28

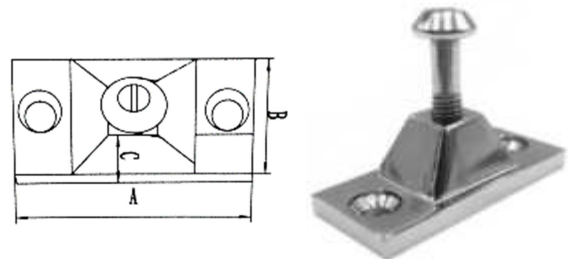

AISI316 SUPPORTO A FORCELLA 90°

Cod.	A mm	B mm
TR5414A	53	26

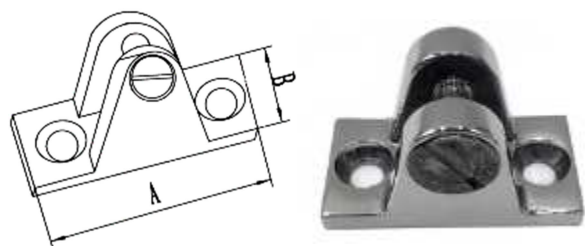

AISI316 BASETTA FISSAGGIO CAPOTTINA 90°

Cod.	L mm	W mm
TR5415A	94.2	27.5



AISI316 BASETTA PER TENDALINI 360°

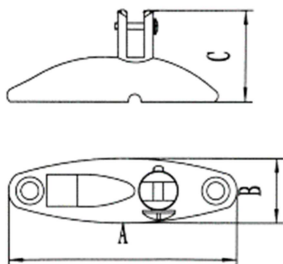

Cod.	Amm	B mm	C mm
TR5416A	81	30	33.5
TR5416B	90	32	34

AISI316 BASETTA PER TENDALINI 360°

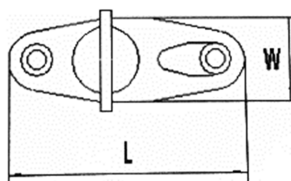

Cod.	L mm	W mm
TR5417A	90.6	30

AISI316 ATTACCO CAPPOTTINA

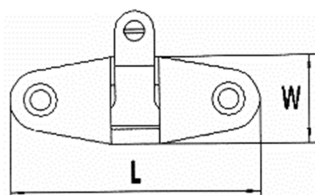

Cod.	L mm	W mm
TR5418A	70	25

AISI316 BASETTA PER TENDALINI CON PERNO REMOVIBILE

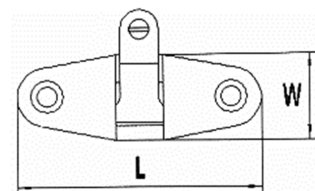

Cod.	L mm	W mm
TR5419A	70	25

AISI316 CORRIMANO UN LATO CHIUSO (INIZIALE 60°)

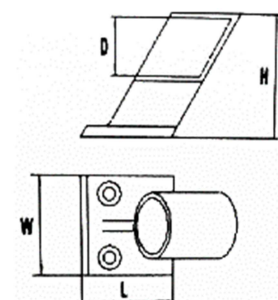

Cod.	Dim.	D	L	W	H
TR5500A	7/8' '	22.5	28	40	45.1
TR5500B	1' '	25.5	29	41	56

AISI316 CORRIMANO (CENTRALE 60°)

Cod.	Dim.	D	L	W	H
TR5501A	7/8' '	22.5	28	40	45
TR5501B	1' '	25.5	29	41	56

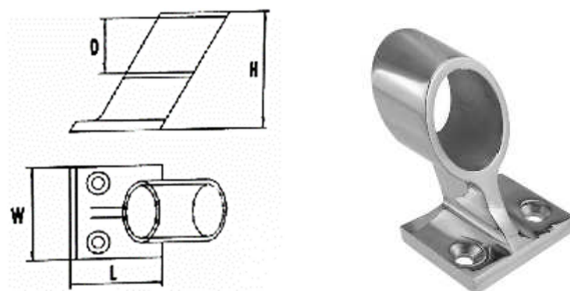

AISI316 CORRIMANO UN LATO CHIUSO (FINALE 60°)

Cod.	Dim.	D	L	W	H
TR5502A	7/8' '	22.5	28	40	45.1
TR5502B	1' '	25.5	29	41	56

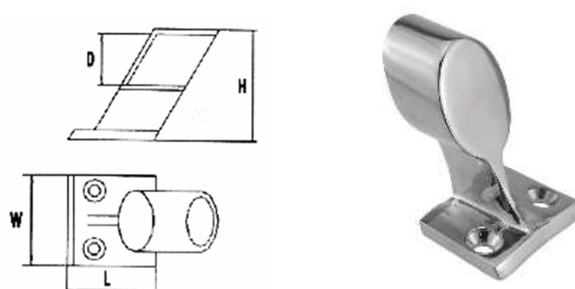

AISI316 CORRIMANO UN LATO CHIUSO (INIZIALE 60°)

Cod.	Dim.	D	L	W	H
TR5504A	7/8' '	22.5	30	36	66.2
TR5504B	1' '	25.6	31	35	69.2

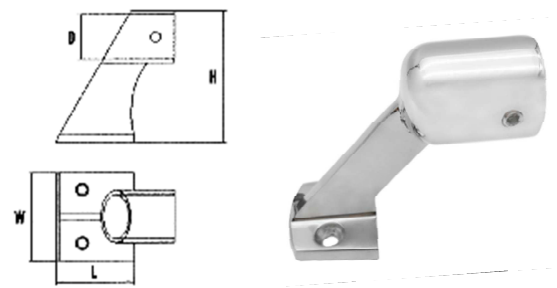

...

AISI316 CORRIMANO (CENTRALE 90°)

Cod.	L1	L2	W	H1	D1
TR5411	67	50.5	22.5	60	25.8

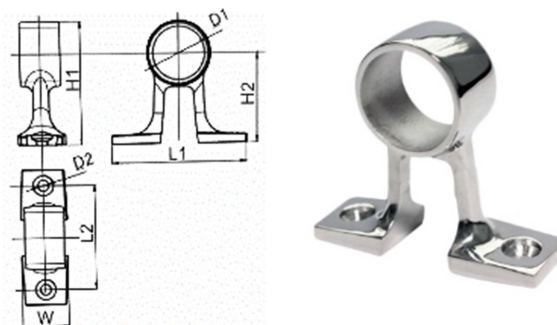

AISI316 CORRIMANO UN LATO CHIUSO (FINALE 90°)

Cod.	L1	L2	W	H1	D1
TR5412	67	51.8	30	60	25.8

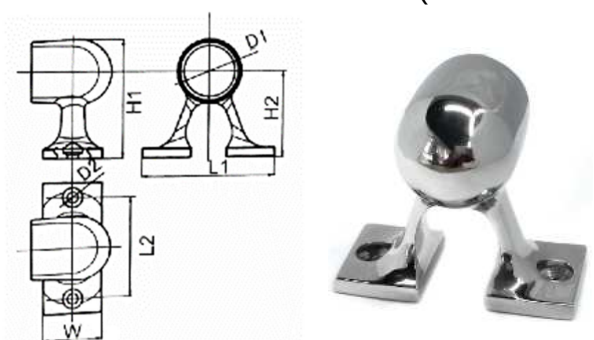

BASI E RACCORDI PULPITO

AISI316 BASE PER PULPITO 30°TONDA

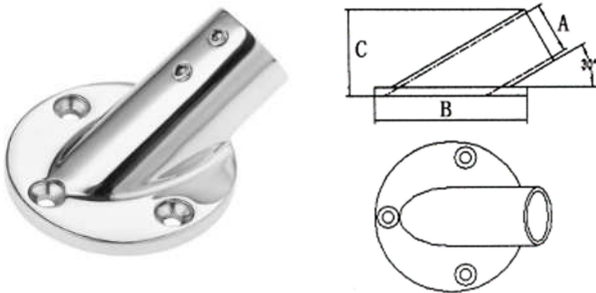

Cod.	Dim.	A mm	B mm	C mm
TR5413-3022	7/8" "	22.5	66.3	37.8
TR5413-3025	1" "	25.6	72.2	36.7

AISI316 BASE PER PULPITO 45°TONDA

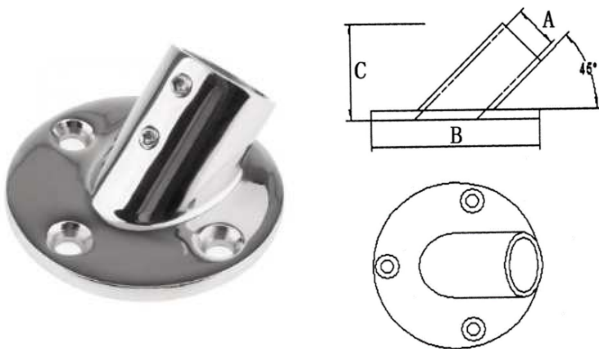

Cod.	Size	A mm	B mm	C mm
TR5414-4522	7/8" "	22.5	66.3	38.1
TR5414-4525	1" "	25.5	72.2	37.9

AISI316 BASE PER PULPITO 60° TONDA

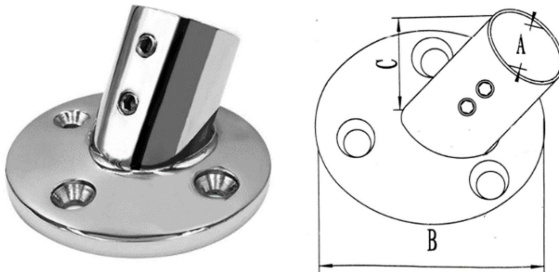

Cod.	Dim.	A mm	B mm	C mm
TR5415-6022	7/8" "	22.5	66.3	41.1
TR5415-6025	1" "	25.5	72.2	40
TR5415-6030	1-1/5" "	30.5	71.5	46
TR5415-6032	1-1/4" "	32.5	71.5	46

AISI316 BASE PER PULPITO 90°TONDA

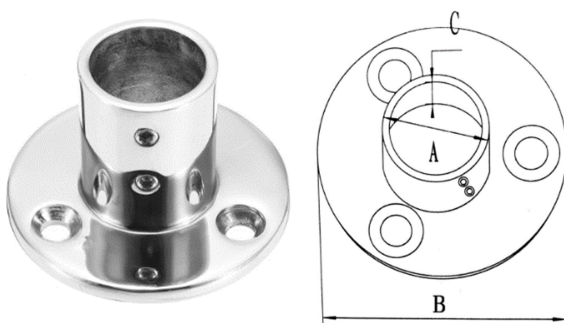

Cod.	Dim.	Amm	B mm	C mm
TR5416-9022	7/8" "	22.5	66	44.7
TR5416-9025	1" "	25.5	69	44.7
TR5416-9030	1-1/5" "	30.5	72	43.2
TR5416-9032	1-1/4" "	32.5	75	43.2

AISI316 RACCORDO PER PULPITO 30° RETTANGOLARE

Cod.	Dim.	A	B	C	D
TR5417-3022	7/8' '	78.7	44	35.6	22.5
TR5417-3025	1' '	82	47.3	38	25.5

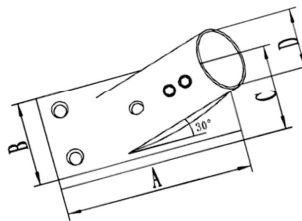

AISI316 RACCORDO PER PULPITO 45°RETTANGOLARE

Cod.	Dim.	A	B	C	D
TR5418-4522	7/8' '	78.7	44	39	22.5
TR5418-4525	1' '	82	47.3	43.6	25.5

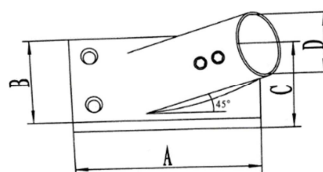

AISI316 RACCORDO PER PULPITO 60°RETTANGOLARE

Cod.	Dim.	A	B	C	D
TR5419-6022	7/8' '	79	44	39	22.5
TR5419-6025	1' '	82	47.3	44	25.5
TR5419-6030	1-1/5' '	86	52	51.6	30.5
TR5419-6032	1-1/4' '	86	52	51	32.5

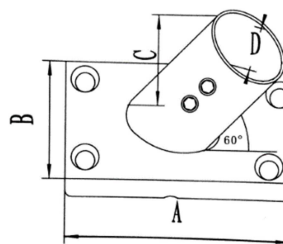

AISI316 RACCORDO PER PULPITO 90°RETTANGOLARE

Cod.	Dim.	A	B	C	D
TR5420-9022	7/8' '	79	44	44	22.5
TR5420-9025	1' '	82	47	47	25.5
TR5420-9030	1-1/5' '	86	52	51	30.5
TR5420-9032	1-1/4' '	87	52	53	32.5

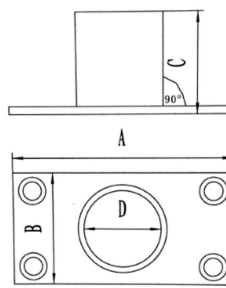

AISI316 BASE PULPITO A SALDARE 90° RETTANGOLARE

Cod.	Dim.	D	L	W	H
TR5437-22	7/8' '	22	78	44	16
TR5437-25	1' '	25	78	44	16

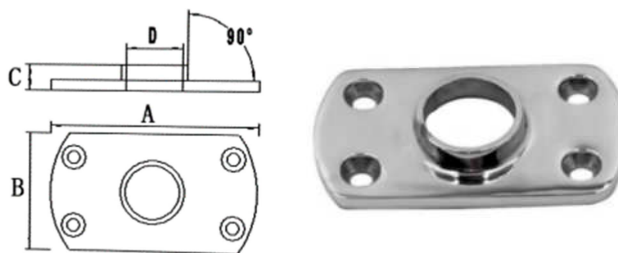

AISI316 BASETTA CONICA 60°

Cod.	Dim.	D mm	H mm
TR5438-25	1' '	25	69
TR5438-30	1-1/5' '	30	80

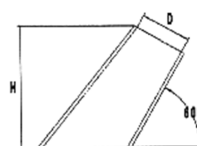

AISI316 BASETTA CONICA 90°

Cod.	Dim.	A mm	B mm
TR5439-25	1' '	25	69
TR5439-30	1-1/5' '	30	80

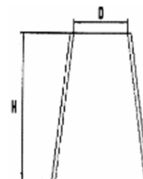

AISI316 BASETTA TRONCO OVOIDALE 60°

Cod.	Dim.	A mm	B mm
TR5440-25	1' '	25	66.5
TR5440-30	1-1/5' '	30	61
TR5440-32	1-1/4' '	32	61

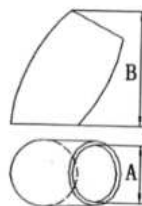

AISI316 BASETTA 90°

Cod.	Dim.	A mm	B mm
TR5441-25	1' '	25	56
TR5441-30	1-1/5' '	30	61
TR5441-32	1-1/4' '	32	61

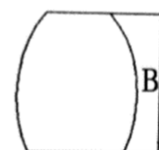

AISI316 SUPPORTO PASSAMANO PASSANTE

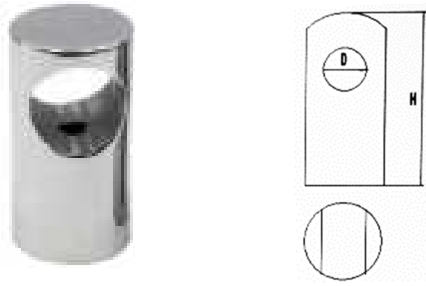

Cod.	D mm	H mm
TR5442A-22	22.5	59
TR5442B-25	25.6	64

AISI316 SUPPORTO PASSAMANO UN LATO CHIUSO

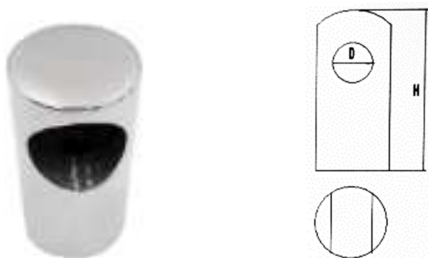

Cod.	D mm	H mm
TR5443A-22	22.6	59
TR5443B-25	25.7	64

AISI316 RACCORDO A GOMITO PULPITO 90°

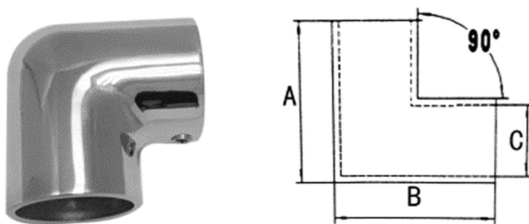

Cod.	Dim.	A mm	B mm	C mm
TR5445-22	7/8' '	50	50	22.6
TR5445-25	1' '	51	51	25.7
TR5445-30	1-1/5' '	54	54	30.5
TR5445-32	1-1/4' '	55	55	32.6

AISI316 RACCORDO A "T" PULPITO 60°

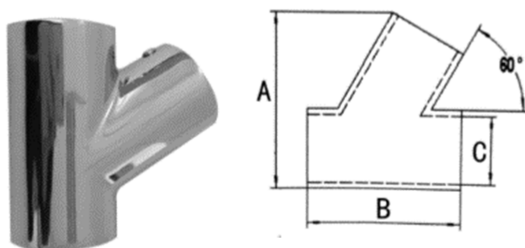

Cod.	Dim.	A mm	B mm	C mm
TR5446-22	7/8' '	57	48	22.5
TR5446-25	1' '	60	52	25.5
TR5446-30	1-1/5' '	76	76	30.5
TR5446-32	1-1/4' '	76	77	32.6

AISI316 RACCORDO A "T" PULPITO MANO SINISTRA 60°



Cod.	Dim.	A mm	B mm	Cmm
TR5447-22	7/8' '	22.6	48	57
TR5447-14	1' '	25.5	52	60

AISI316 RACCORDO A "T" "PULPITO MANO DESTRA 60°

Cod.	Dim.	A mm	B mm	C mm
TR5448-22	7/8" ' '	22.6	48	57
TR5448-25	1" ' '	25.5	52	60

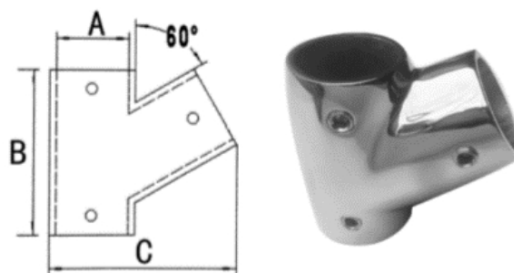

AISI316 RACCORDO A "T" PULPIYO 90°

Cod.	Dim.	A mm	B mm	C mm
TR5449-22	7/8" ' '	22.5	52	51
TR5449-25	1" ' '	25.5	53	51
TR5449-30	1-1/5" ' '	30.6	76	83
TR5449-32	1-1/4" ' '	32.5	76	88

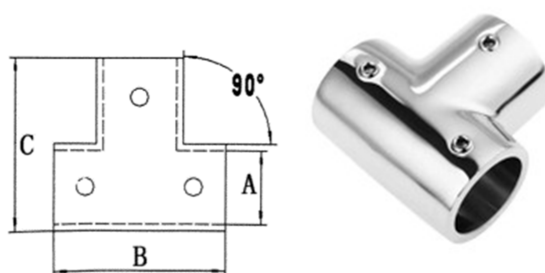

AISI316 RACCORDO A "T" PULPITO 90°

Cod.	Dim.	D mm	L mm	W mm
TR5450-22	7/8" ' '	22.5	52	52
TR5450-25	1" ' '	25.5	55	55

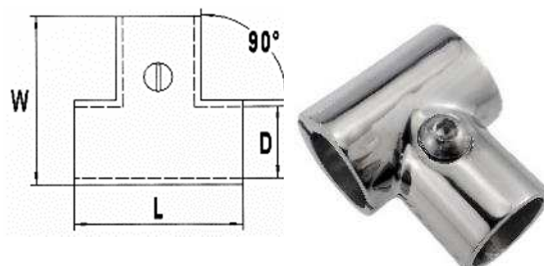

AISI316 RACCORDO A "T" PULPITO 60°

Cod.	Dim.	D mm	L mm	W mm
TR5451-22	7/8" ' '	22.5	48	57
TR5451-25	1" ' '	25.6	52	60

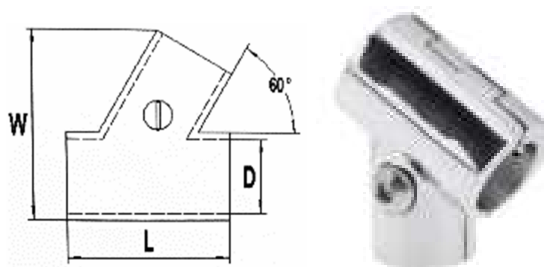

AISI316 RACCORDO A "T" PULPITO 60°

Cod.	Dim.	D mm	L mm	W mm
TR5452-22	7/8" ' '	22.5	48	57

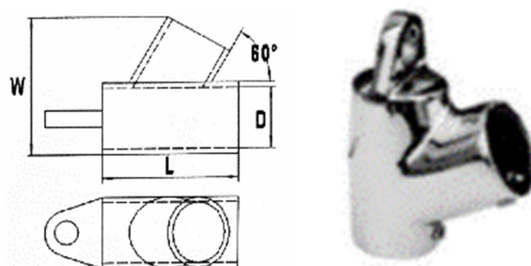

AISI316 RACCORDO A "T" PULPITO 90°

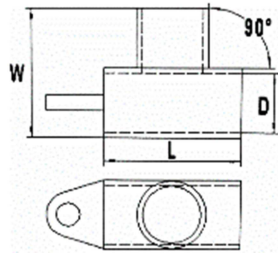

Cod.	Dim.	D mm	L mm	W mm
TR5452-22	7/8' '	22.5	52	52

AISI316 RACCORDO A "T" PULPITO A 3 VIE 90°

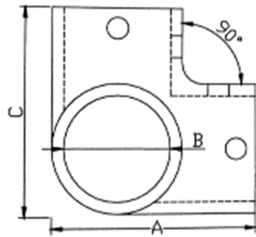

Cod.	Dim.	A mm	B mm	C mm
TR5454-22	7/8' '	49.2	22.5	49.2
TR5454-25	1' '	49	25.5	49
TR5454-30	1-1/5' '	49	30.6	49
TR5454-32	1-1/4' '	57	32.5	57

AISI316 RACCORDO A "T" PULPITO A 4 VIE 90°

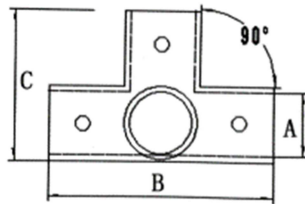

Cod.	Dim.	A mm	B mm	C mm
TR5454-22	7/8' '	22.5	72.4	51
TR5454-25	1' '	25.5	71.7	51.4

AISI316 RACCORDO A CROCE PULPITO 90°

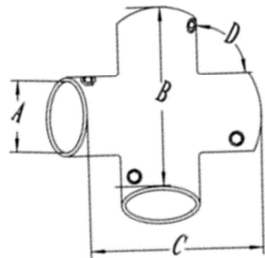

Cod.	Dim.	A mm	B mm	C mm
TR5455-22	7/8' '	22.5	72.4	72.4
TR5455-25	1' '	25.6	71.7	71.7
TR5455-30	1-1/5' '	30.5	75	75

AISI316 RACCORDO AD ARCO

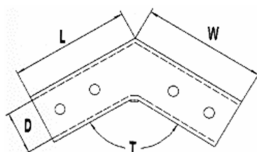

Cod.	Dim.	D	L	W	T
TR11022-11022	7/8' '	22.5	63	63	110°
TR11025-11025	1' '	25.6	63	63	110°
TR12022-12022	7/8' '	22.7	64	64	120°
TR12025-12025	1' '	25.6	64	64	120°
TR12522-12522	7/8' '	22.7	64	64	125°
TR12525-12525	1' '	25.6	64	64	125°
TR14022-14022	7/8' '	22.5	59	59	140°
TR14025-14025	1' '	25.6	59	59	140°

AISI316 ANGOLARE DI PRUA 90°

Cod.	Dim.	D mm	Degree
TR5456-22	7/8' '	22.5	90°

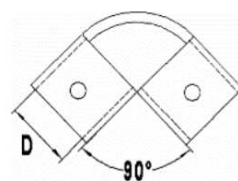

AISI316 BASE CIECA

Code	Dim.	D mm	L mm	H mm
TR5457-25	1' '	25.5	87	34.2

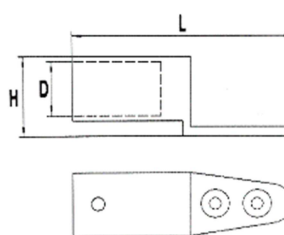

AISI316 GIUNTO SNODATO

Cod.	Dim	D mm	L mm
TR5458-22	7/8' '	22.5	37.4
TR5458-25	1' '	25.6	37.7

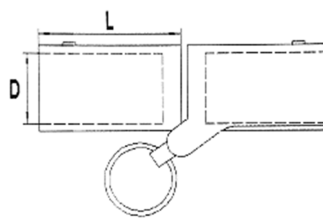

AISI316 GIUNTO SNODATO

Cod.	Dim.	D mm	L mm
TR5459-22	7/8' '	22.5	38.2
TR5459-25	1' '	25.5	39.2

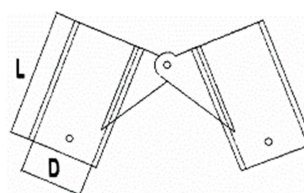

AISI316 GIUNTO SNODATO

Cod.	D1 mm	D2 mm
TR5461A-20	17.5	20.2
TR5461B-20	17	20
TR5461C-22	19.4	22
TR5461D-22	18.8	22

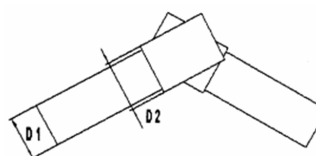

AISI316 TERMINALE CORRIMANO

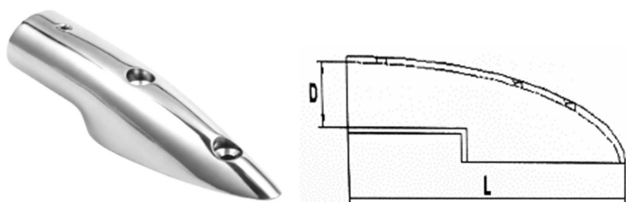

Cod.	Dim.	D mm	L mm
TR5470A-22	7/8" "	22	119

AISI316 TERMINALE CORRIMANO

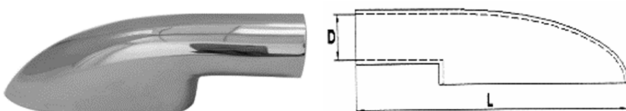

Cod.	Dim.	D mm	L mm
TR5471A-22	7/8" "	22.5	175
TR5471B-25	1" "	25.6	175

AISI316 TERMINALE CORRIMANO



Cod.	A mm	B mm
TR5473A-19	110	19.6

AISI316 STAFFA DI SUPPORTO

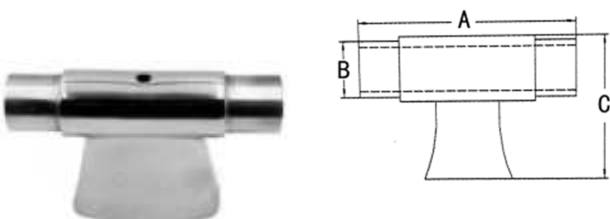

Cod.	A mm	B mm	C mm
TR5474A-25	100	25	61

AISI316 BASETTA PER PULPITO

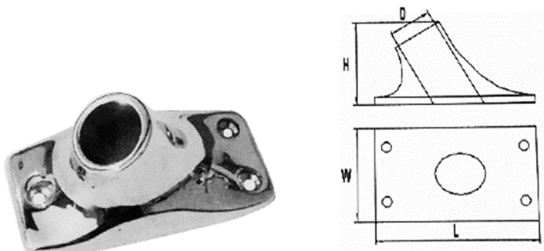

Cod.	D mm	L mm	W mm	H mm
TR5481A	14	85.6	40.5	33.2
TR5481B	20	86	42	44.4
TR5481C	25	90.5	45	52

AISI316 TERMINALE

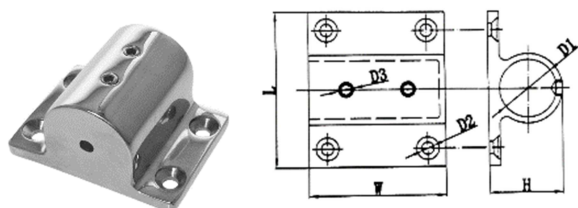

Cod.	Size	L mm	W mm	D1 mm
TR5482A-22	7/8" "	45.3	57.3	22.6
TR5482B-25	1" "	61.8	45.3	25.7

CERNIERE Spessore standard 4 mm

AISI316 CERNIERA PRESSOFUSA

Cod.	A mm	B mm
TR07638	76	38



AISI316 CERNIERA PRESSOFUSA

Cod.	A mm	B mm
TR10238A	102	38
TR10738B	107	38

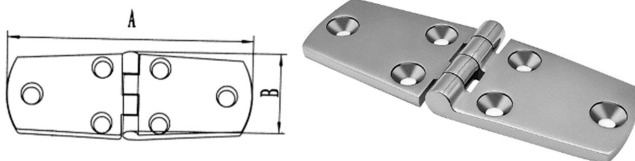

AISI316 CERNIERA PRESSOFUSA

Cod.	L mm	W mm
TR05738A	57	38
TR07638B	76	38

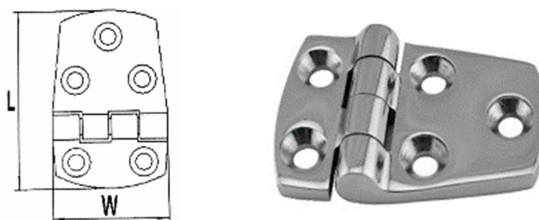

AISI316 CERNIERA PRESSOFUSA

Cod.	A mm	B mm
TR4040A	40	40
TR5050B	50	50
TR7575C	75	75

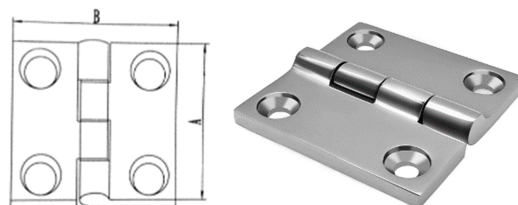

AISI316 CERNIERA PRESSOFUSA

Cod.	L mm	W mm
TR5437A	54	37
TR7037B	70	37

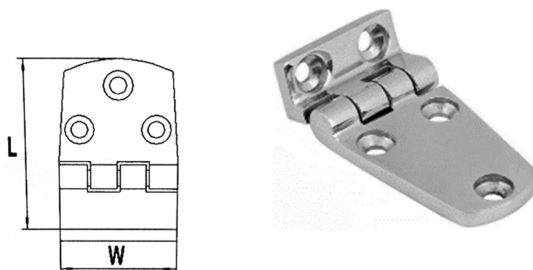

AISI316 CERNIERA PRESSOFUSA

Cod.	L mm	W mm
TR6037A	60	37

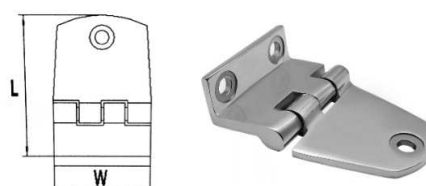

AISI316 CERNIERA PRESSOFUSA

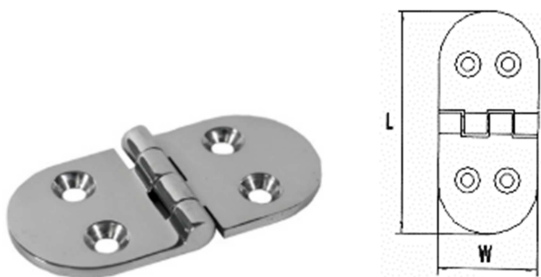

Cod.	L mm	W mm
TR7638A	76	38

AISI316 CERNIERA PRESSOFUSA

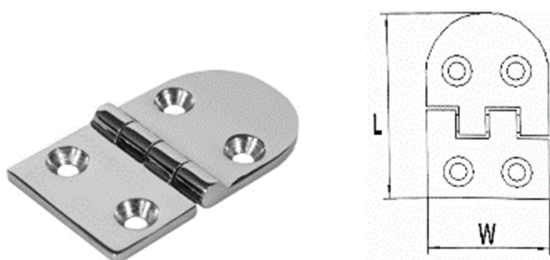

Cod.	L mm	W mm
TR7040A	70	40
TR8164A	81	64

AISI316 CERNIERA PRESSOFUSA

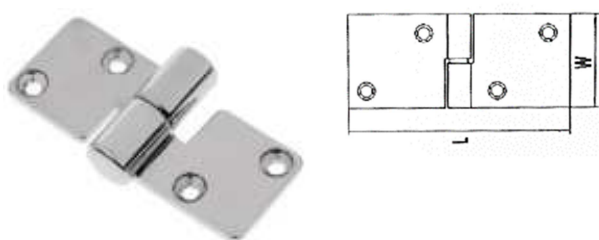

Cod.	L mm	W mm
TR9038L	90	38
TR9038R	90	38

AISI316 CERNIERA PRESSOFUSA

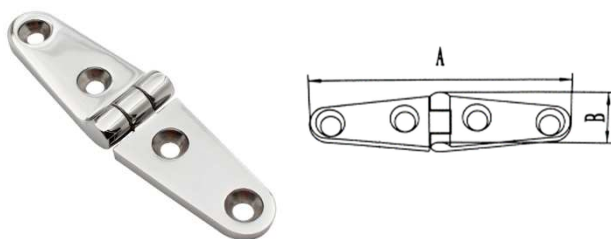

Cod.	A mm	B mm
TR10327	103	27

AISI316 CERNIERA PRESSOFUSA



Cod.	A mm	B mm
TR15230	152	30

AISI316 CERNIERA PRESSOFUSA

Cod.	A mm	B mm
TR17018	170	18

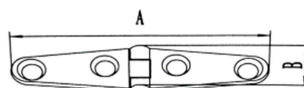

AISI316 CERNIERA PRESSOFUSA

Cod.	L mm	W mm
TR11038	110	38

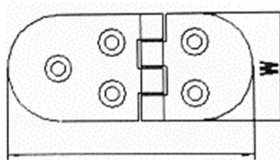

AISI316 CERNIERA PRESSOFUSA

Cod.	L mm	W mm
TR07835A	78	35
TR17140B	171	40
TR18963C	189	63
TR22564D	225	64

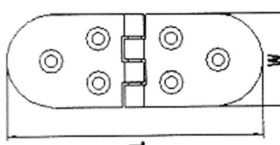

AISI316 CERNIERA PRESSOFUSA

Cod.	L mm	W mm
TR14038A	140	38
TR14438B	147	38

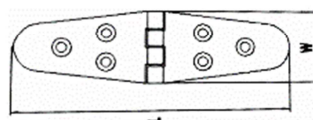

AISI316 CERNIERA PRESSOFUSA

Cod.	L mm	W mm
TR10054A	100	54
TR15175B	151	75
TR20097C	200	97

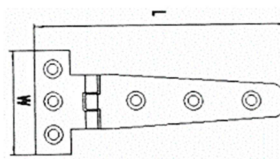

AISI316 CERNIERA TONDA PRESSOFUSIONE

Cod.	L mm	W mm
TR06565	65	65



AISI316 CERNIERA PRESSOFUSA

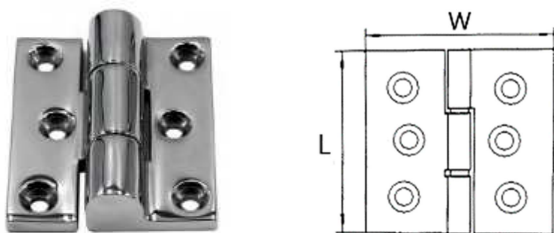

Cod.	L mm	W mm
TR08070A	80	70

AISI316 CERNIERA PRESSOFUSA

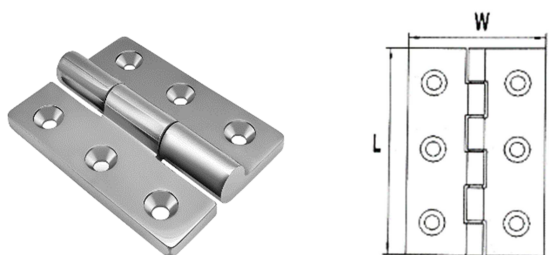

Cod.	L mm	W mm
TR10070A	100	70
TR12090B	120	90

AISI316 CERNIERA PRESSOFUSA

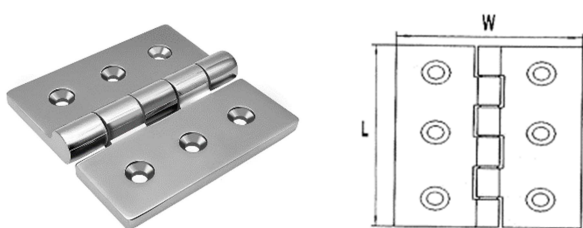

Cod.	L mm	W mm
TR100100A	100	100

AISI316 CERNIERA PRESSOFUSA

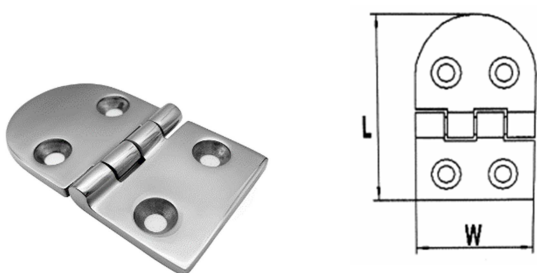

Cod.	L mm	W mm
TR07040A	70	40
TR08365B	83	65
TR10365C	103	65

AISI316 CERNIERA PRESSOFUSA



Cod.	L mm	W mm
TR6629A	66	29

AISI316 CERNIERA PRESSOFUSA



Cod.	L mm	W mm
TR20038A	200	38

AISI316 CERNIERA PRESSOFUSA

Cod.	L mm	W mm
TR18664A	186	64



AISI316 CERNIERA PRESSOFUSA

Cod.	L mm	W mm
TR09449A	94	49

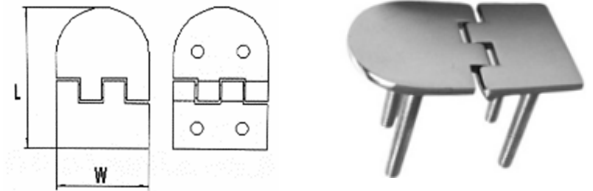

AISI316 CERNIERA PRESSOFUSA

Cod.	L mm	W mm
TR8959A	89	59



AISI316 CERNIERA PRESSOFUSA PORTELLO

Cod.	A mm	B mm
TR7654A	76	54.3

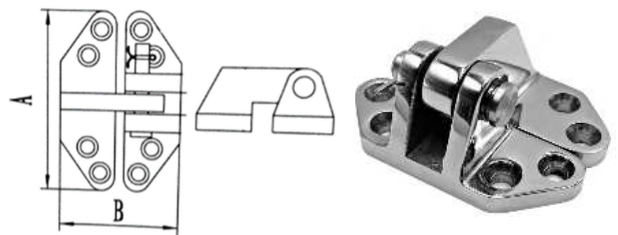

AISI316 CERNIERA PRESSOFUSA PORTELLO

Cod.	A mm	B mm
TR7665B	76	65.5



AISI316 CERNIERA PRESSOFUSA PORTELLO

Cod.	A mm	B mm
TR7165A	71	65.5

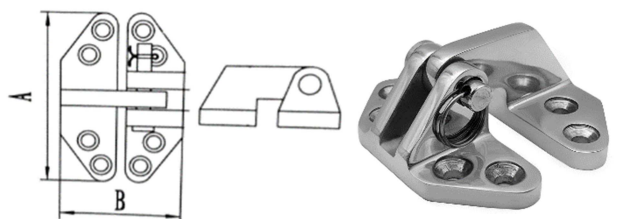

ALZAPAGLIOLI

AISI316 ALZAPAGLIOLO

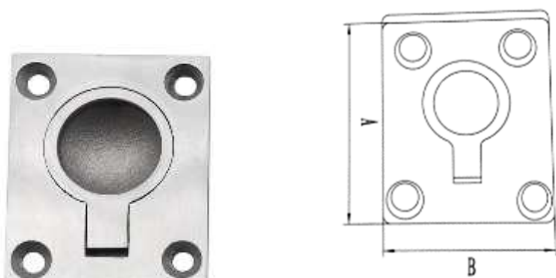

Cod.	A mm	B mm
TR04838A	48	38

AISI316 ALZAPAGLIOLO

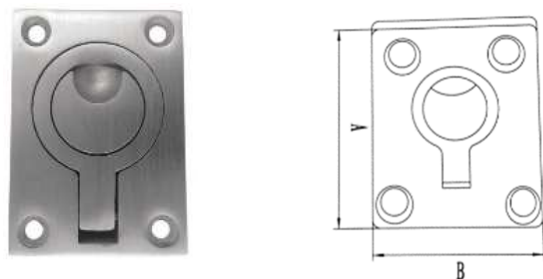

Cod.	A mm	B mm
TR6244B	62	44

AISI316 ALZAPAGLIOLO TONDO

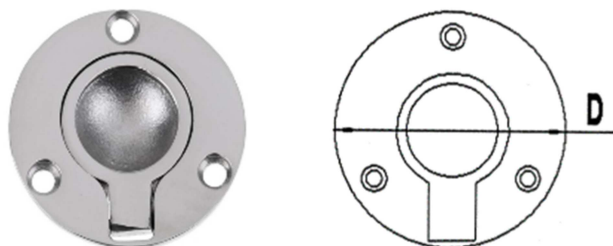

Cod.	D mm
TR05050A	50

AISI316 ALZAPAGLIOLO QUADRATO CON MOLLA

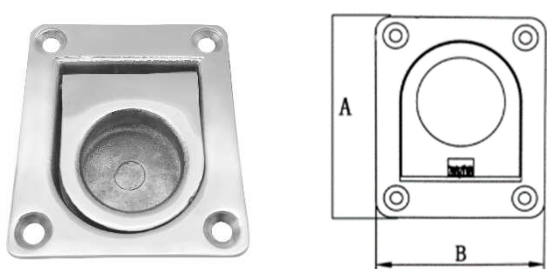

Cod.	A mm	B mm
TR4438A	44	38
TR6555B	65	55

AISI316 ALZAPAGLIOLO

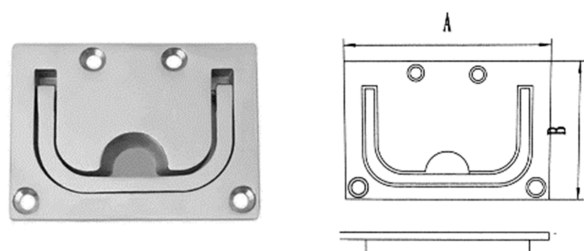

Cod.	A mm	B mm
TR7658A	76	58

AISI316 ALZAPAGLIOLO DI CHIUSURA

Cod.	D1 mm	D2 mm	H1 mm	H2mm
TR6250A	62	50.5	11.5	37.4

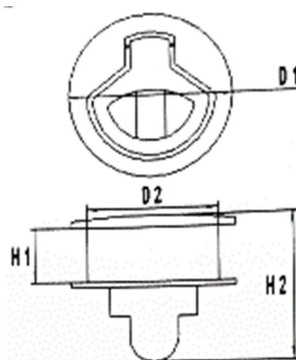

AISI316 ALZAPAGLIOLO DI CHIUSURA

Cod.	D1 mm	D2mm	H1mm	H2mm
TR6250B	62	50.5	11.5	37.4

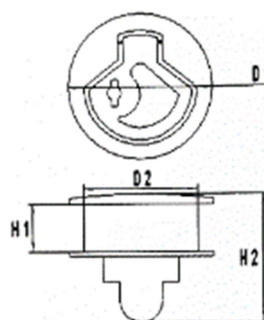

AISI316 ALZAPAGLIOLO DI CHIUSURA

Cod.	D1 mm	D2mm	H1mm	H2mm
TR6250C	62	50.5	11.5	69

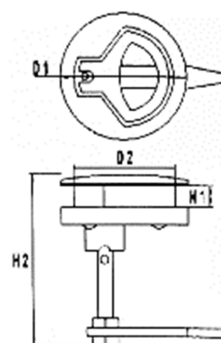

AISI316 ALZAPAGLIOLO DI CHIUSURA

Cod.	A mm	Bmm	Cmm
TR7967A	79	67	109

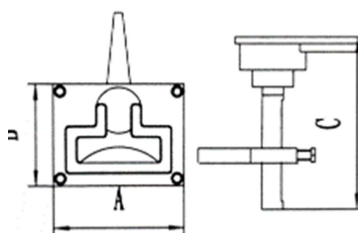

AISI316 ALZAPAGLIOLO DI CHIUSURA

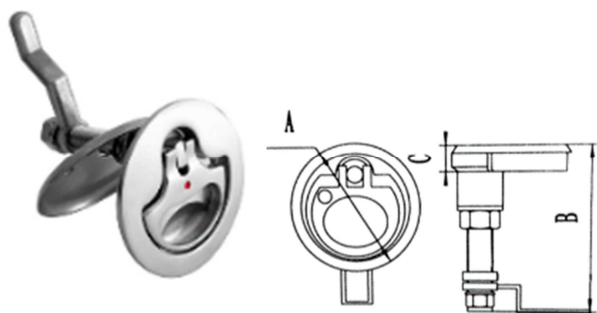

Cod.	A mm	B mm	C mm
TR6472A	64	72	13

AISI316 ALZAPAGLIOLO DI CHIUSURA

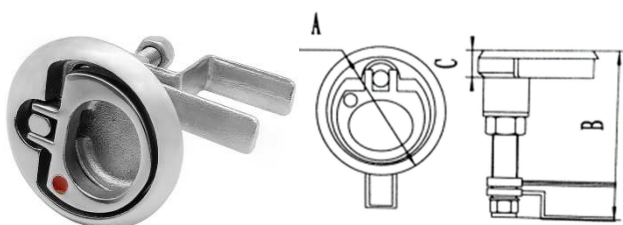

Cod.	A mm	B mm	C mm
TR5084A	50	84	15

AISI316 ALZAPAGLIOLO

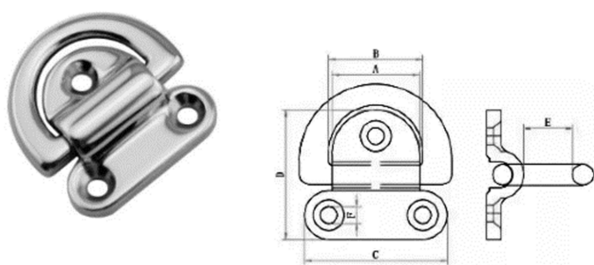

Cod.	A mm	Bmm	Cmm	Dmm
TR19006A	27	29	44	40
TR19008B	34	36	55	49.5
TR19010C	44	47.5	70	65

AISI316 CHIUSURA A LEVA PER GAVONE

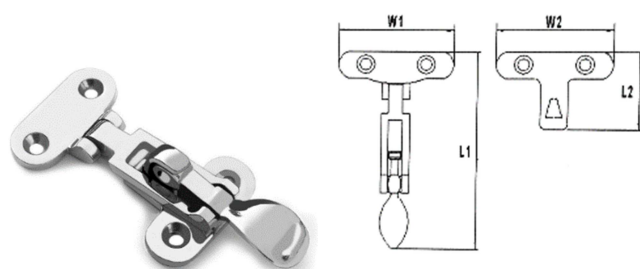

Cod.	L1 mm	L2mm	W1mm	W2mm
TR11238A	112	39	50	50

AISI316 CHIUSURA A LEVA

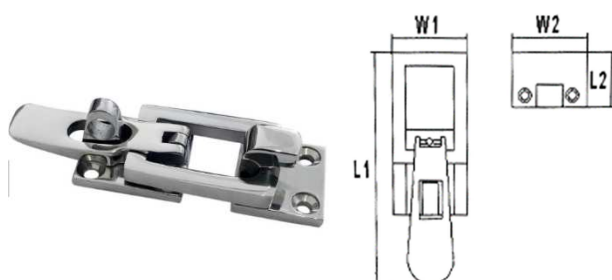

Cod.	L1mm	L2mm	W1mm	W2mm
TR8225A	82.5	25.4	27.8	28

AISI316 CHIUSURA A LEVA

Cod.	L1 mm	L2mm	W1mm	W2mm
TR8225B	82.5	25.4	27.8	28

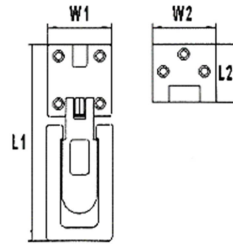

AISI316 CHIAVISTELLO

Cod.	L mm	W mm
TR9039A	90	39
TR11039B	110	39

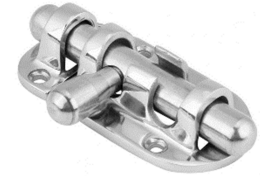
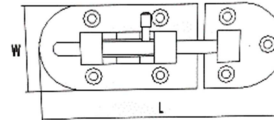

AISI316 FERMAPAGLIOLO

Cod.	D mm
TR4450A	42.5

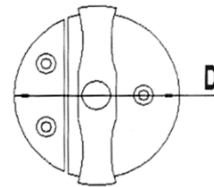

AISI316 TAPPO DI SCARICO

Cod.	D mm
TR05050B	50

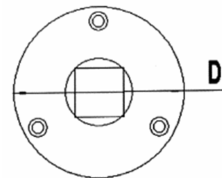

AISI316 TAPPO DI SCARICO

Cod.	B mm
TR5422A	22
TR5425A	25
TR5430A	30

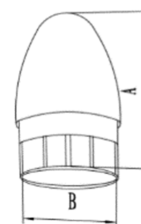

AISI 316 TAPPO DI SCARICO Garboard

Cod.	Amm	B mm	C mm	D mm	F mm
TR19M24	70	41.5	52.5	25.5	31

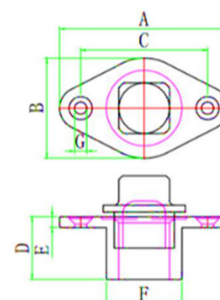

PORTACANNE E ACCESSORI

AISI316 PORTACANNA DA INCASSO



Cod.	Lung.	Diam.int.	Angol.
TR1030A-15	9 inch	1-5/8 inch	15°
TR1060B-30	9 inch	1-5/8 inch	30°
TR1090C-90	9 inch	1-5/8 inch	90°

AISI316 PORTACANNE DA INCASSO



Cod.	Lung.	Diam.int.	Angol.
TR1130A-15	9 inch	1-5/8 inch	15°
TR1160A-30	9 inch	1-5/8 inch	30°
TR1190A-90	9 inch	1-5/8 inch	90°

AISI316 PORTACANNE DA INCASSO



Cod.	Lung.	Diam.int.	Angol.
TR1130B-15	9 inch	1-5/8 inch	15°
TR1160B-30	9 inch	1-5/8 inch	30°
TR1190B-90	9 inch	1-5/8 inch	90°

AISI316 PORTACANNE CON PILETTA DRENAGGIO



Cod.	Lung.	Diam.int.	Angol.
TR1230A-15	9 inch	1-5/8 inch	15°
TR1260A-30	9 inch	1-5/8 inch	30°
TR1290A-90	9 inch	1-5/8 inch	90°
NOTA	Portacanne con drenaggio		

AISI316 PORTACANNE A PARETE SFILABILE



Cod.	Lung.	Diam.int.	Angol.
TR1310A	10 inch	1-1/2 inch	90°

Cod.	Lung.	Diam.int.	Angol.
TR1311B	10 inch	1-1/2 inch	90°

AISI316 PORTACANNE A PARETE



Cod.	Lung.	Diam.int.	Lungh. tubo
TR18290A-360	290mm	1-3/4 inch	8-1/2 inch
NOTA	Girevole a 360 gradi		

AISI316 PORTACANNE DA PESCA REGOLABILE



Cod.	Lung.	Diam.int.	Dim. morsetto
TR1409A	9 inch	1-5/8 inch	7/8inch-1 inch
TR1409B	9 inch	1-5/8 inch	1inch-1-1/4 inch

AISI316 PORTACANNE CON MORSETTO



AISI316 PORTACANNE A MORSETTO

Cod.	Lung.	Diam.int.	Dim. morsetto
TR1509A	9 inch	1-5/8 inch	7/8inch-1 inch
TR1509B	9 inch	1-5/8 inch	1inch-1-1/4inch
TR1509C	9inch	1-5/8 inch	1-1/4inch-2 inch



Cod.	Lung.	Diam.int.	Dim. morsetto
TR1609A	9 inch	1-5/8 inch	7/8inch-1 inch
TR1609B	9 inch	1-5/8 inch	1inch-1-1/4inch
TR1609C	9 inch	1-5/8 inch	1-1/4inch-2 inch

AISI316 PORTACANNE A MORSETTO



SI316 PORTACANNE REGOLABILE



Cod.	For pie size.	Rod holder I.D.
TR1943A	7/8 inch-1 inch	1-3/4 inch
TR1943B	1 inch-1/1/4 inch	1-3/4 inch
TR1943C	1-1/2 inch-1-5/8 inch	1-3/4 inch

AISI316 PORTACANNE REGOLABILE



Cod.	Per tubo diam.	Diam. Int. .
TR20143A	3/4 inch	1-3/4 inch
TR20143B	1 inch	1-3/4 inch
TR20143C	1-1/4 inch	1-3/4 inch

AISI316 PORTACANNE REGOLABILE



Cod.	Per tubo diam.	Diam. Int.
TR22143A	7/8 inch	1-3/4 inch

AISI316 PORTACANNE REGOLABILE



Cod.	Lungh.	Dia. Int.	Lungh.
TR2302A	4inch*3/4inch	1-1/2 inch	8-1/2inch
NOTE	Adjustable For 1 inch Tube		

AISI316 PORTACANNE A INCASSO



Cod.	Lungh.	Diam. Int..	Degree
TR2230A	8.3 inch	φ44.5mm	30°
TR2290A	8.3 inch	φ44.5mm	90°

AISI316 PORTACANNE DA PARETE

Code	Dia. Int.	length
TR2311A	41.6mm	11-1/2 inch



AISI316 PORTACANNE DA PARETE

Code	Lungh. tubi	Largh. Tot.
TR3016A	9 inch	16-1/4 inch



AISI316 PORTACANNE DA PARETE

Code	Diam. Int..	Largh. Tot.
TR3601A	1-1/2 inch	36-1/2 inch



AISI316 REGGICANNA RIALZATO

Cod.	Diam. Int.	Lungh.	Lungh. tubo
TR2240A	1-1/2 inch	11-1/2 inch	19-1/2 inch



AISI316 REGGICANNA RIALZATO REGOLABILE

Cod.	Diam. Int.	Lungh.	Lungh. tubo
TR2230A	1-1/2 inch	11-1/2 inch	19-1/2 inch



AISI316 PORTACANNE A MORSETTO



Code	Dim.	Lungh.	Diam.tubo
TR3381A-25	1' '	6.8 inch	25mm
TR3382B-32	1-1/4' '	6.8 inch	32mm

AISI316 PORTACANNE MULTIPLO



Code	Dia. Int.	Lungh.
TR3682A	1-3/4 inch	24-7/8 inch

AISI316 PORTACANNE DA PESCA



Cod.	Diam. Int.	Lungh.
TR3783A	1-3/4 inch	24-7/8 inch

AISI316 PORTACANNE



Cod.	Diam. Ont.	Lungh.
TR3412A	1-3/4 inch	12-1/4 inch

AISI316 PORTACANNE



Cod.	Lungh.	Largh.	Base
TR2472A	16.3 inch	10 inch	4.72inch*2.7inch

AISI316 PORTACANNE REGOLABILE



Cod.	Largh.	Lungh. supporto canna
TR4058A	1-1/2inch-1-5/8inch	10inch

AISI316 SCARICHI – FILTRI-SFIATI

SCARICO A MARE A FILO

Cod.	Dim.	D mm	H mm
TR1101A	3/8 inch	16.5	54
TR1102A	1/2 inch	21	59
TR1103A	3/4 inch	26	69
TR1104A	1 inch	33.5	72
TR1105A	1-1/4 inch	43	78.6
TR1106A	1-1/2 inch	48	79.3
TR1107A	2 inch	60	95
TR1108A	2-1/2 inch	75	110
TR1109A	3 inch	88	120

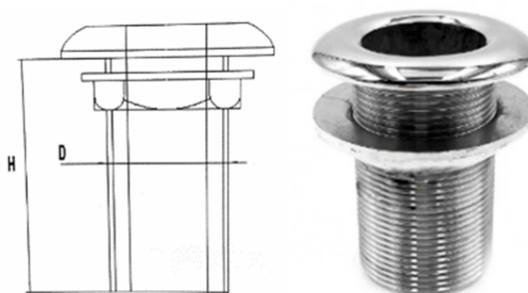

SCARICO A MARE

Cod.	Dim.	D1 mm	D2 mm	H mm
TR1101B	1/2 inch	16.5	14	53
TR1102B	3/4 inch	21	18.5	61
TR1103B	7/8 inch	26	23	70
TR1104B	1 inch	33	26	72
TR1105B	1-1/4 inch	42	33.5	78
TR1106B	1-1/2 inch	42	39.5	79
TR1107B	1-3/4 inch	49	46	85
TR1108B	2 inch	59	52	98

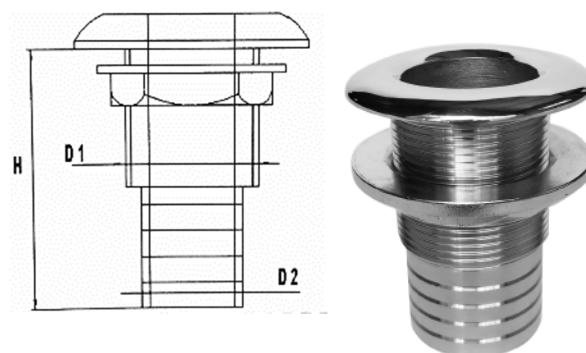

SCARICO A MARE CON PORTAGOMMA

Cod.	D1 mm	D2 mm	H mm
TR1201A	1/2 inch	14	87
TR1202A	3/4 inch	18	96
TR1203A	1 inch	24.5	95.5
TR1204A	1-1/4 inch	32	87
TR1205A	1-1/2 inch	38	97

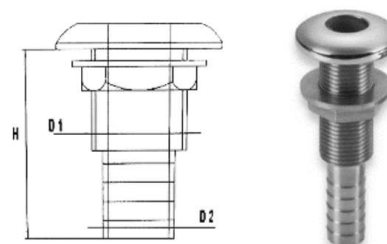

AISI316 SCARICO DA POZZETTO

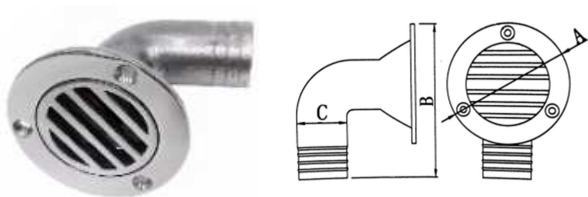

Cod.	Dim.	Amm	B mm	C mm
TR1401A-32	32MM	79	103	32.5
TR1402A-38	38MM	79	103	38.5

AISI316 SCARICO DA POZZETTO

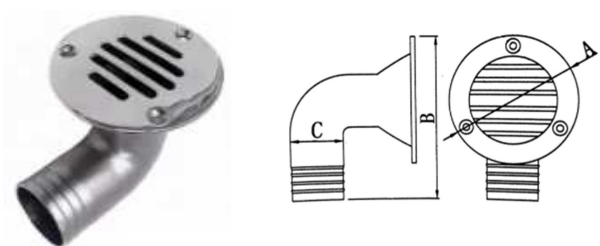

Cod.	Dim.	A mm	B mm	C mm
TR1501A-32	32MM	79	103	32.5
TR1502A-38	38MM	79	103	38.5

AISI316 SCARICO DA POZZETTO

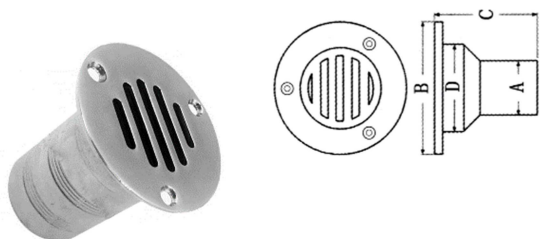

Cod.	Dim.	A mm	B mm	C mm
TR1601A-50	2' '	51	82	80

AISI316 SCARICO DA POZZETTO

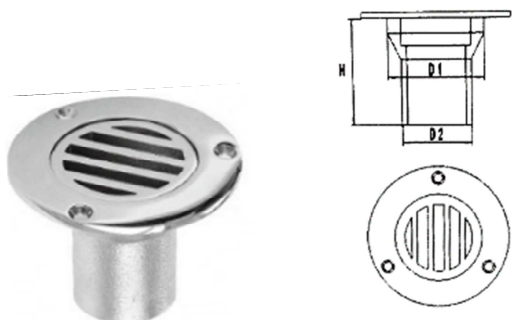

Cod.	Dim.	D1	D2 mm	H mm
TR1602A-38	1-1/2' '	58	38	60

AISI316 SCARICO DA POZZETTO CON NON RITORNO

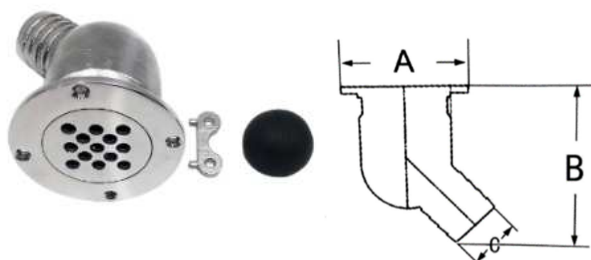

Cod.	Size	A mm	B mm	C mm
TR1701A-38	1-1/2' '	92	115	40

Cod.	Dim.	A	B	C	D	E
TR1801	3/8 inch	90	82	16.5	11	65
TR1802	1/2 inch	90	82	21	12.5	66
TR1803	3/4 inch	107	104	26	18.5	80
TR1804	1 inch	106	106	33	25.5	76
TR1805	1-1/4 inch	103	117	42	32	78
TR1806	1-1/2 inch	109	133	47.5	38	80
TR1807	2 inch	124	152	60	50	91

AISI316 PRESA A MARE

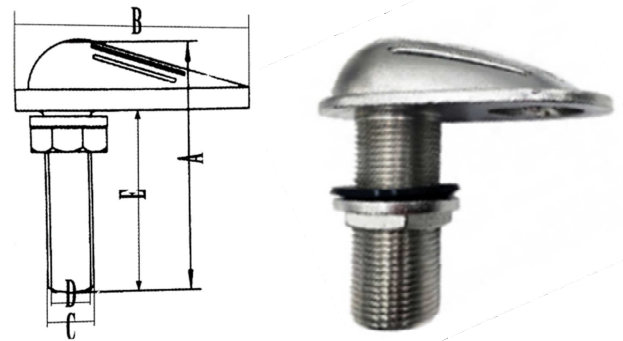

AISI316 SFIATO CARBURANTE

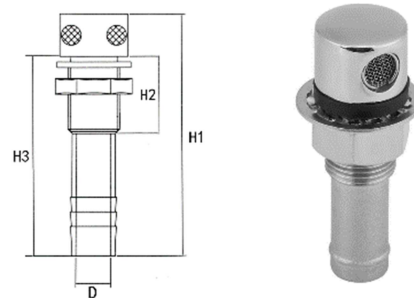

Cod.	D mm	H1 mm	H2 mm	H3 mm
TR2880A	16	82	28	70

AISI316 SFIATO CARBURANTE

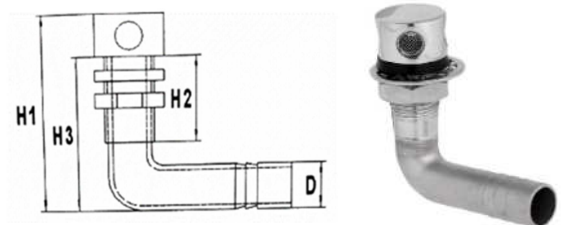

Cod.	D mm	H1 mm	H2 mm	H3 mm
TR2880B	16	84	28	49

AISI316 SFIATO CARBURANTE A FILO

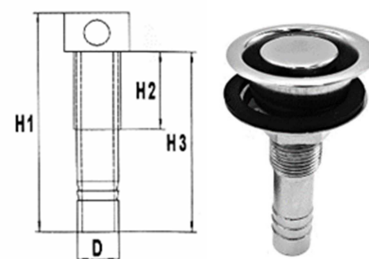

Cod.	D mm	H1 mm	H2 mm	H3 mm
TR2881A	16	84	28	70

AISI316 SFIATO CARBURANTE A FILO

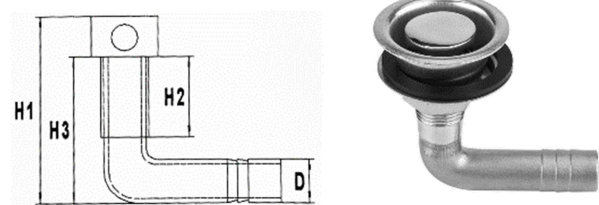

Cod.	D mm	H1 mm	H2 mm	H3 mm
TR2881B	16	84	28	49

IMBARCHI

AISI316 TAPPO DI RIFORNIMENTO

(SENZA CHIAVE)

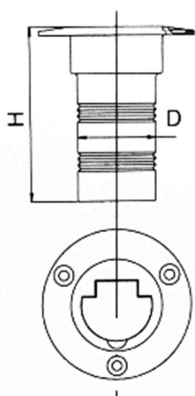

Cod.	Modello	D mm	H mm
TR1038-FUEL	FUEL	38	80
TR1050-FUEL	FUEL	50	80
TR1138-DIESEL	DIESEL	38	80
TR1150-DIESEL	DIESEL	50	80
TR1238-WASTE	WASTE	38	80
TR1250-WASTE	WASTE	50	80
TR1338-GAS	GAS	38	80
TR1350-GAS	GAS	50	80
TR1438-WATER	WATER	38	80
TR1450-WATER	WATER	50	80

AISI316 TAPPO DI RIFORNIMENTO

(CON CHIAVE)

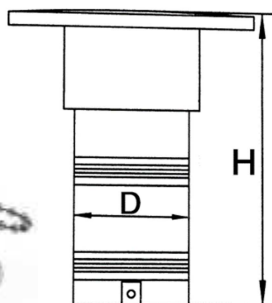

Cod.	Modello	D mm	H mm
TR2038-FUEL	FUEL	38	80
TR2050-FUEL	FUEL	50	80
TR2138-DIESEL	DIESEL	38	80
TR2150-DIESEL	DIESEL	50	80
TR2238-WASTE	WASTE	38	80
TR2250-WASTE	WASTE	50	80
TR2338-GAS	GAS	38	80
TR2350-GAS	GAS	50	80
TR2438-WATER	WATER	38	80
TR2450-WATER	WATER	50	80

AISI316 TAPPO DI RIFORNIMENTO

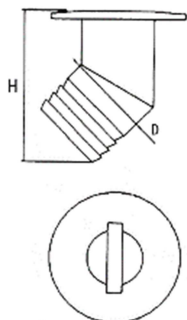

Code	Model	D mm	H mm
TR3038-FUEL	FUEL	38	78
TR3050-FUEL	FUEL	50	97
TR3138-DIESEL	DIESEL	38	78
TR3150-DIESEL	DIESEL	50	97
TR3238-WASTE	WASTE	38	78
TR3250-WASTE	WASTE	50	97
TR3438-WATER	WATER	38	78
TR3450-WATER	WATER	50	97

AISI316 TAPPO DI RIFORNIMENTO

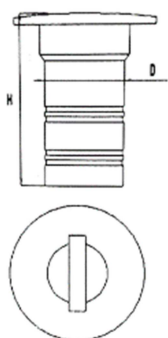

Code	Model	D mm	H mm
TR4038-FUEL	FUEL	38	87.1
TR4050-FUEL	FUEL	50	87.1
TR4138-DIESEL	DIESEL	38	87.1
TR4150-DIESEL	DIESEL	50	87.1
TR4238-WASTE	WASTE	38	87.1
TR4250-WASTE	WASTE	50	87.1
TR4438-WATER	WATER	38	87.1
TR4450-WATER	WATER	50	87.1

Code	Model	A mm	H mm
TR5038-FUEL	FUEL	38	76
TR5050-FUEL	FUEL	50	91
TR5138-DIESEL	DIESEL	38	76
TR5150-DIESEL	DIESEL	50	91
TR5238-WASTE	WASTE	38	76
TR5250-WASTE	WASTE	50	91
TR5338-WATER	WATER	38	76
TR5350-WATER	WATER	50	91
TR5438-GAS	GAS	38	76
TR5450-GAS	GAS	50	91

ISI316 TAPPO DI RIFORMIMENTO

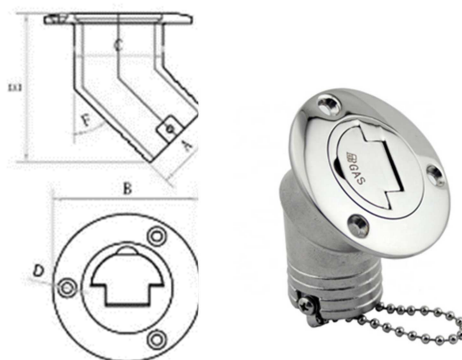

TAPPO RIFORMIMENTO ACQUA IN PLASTICA

Cod.	A mm	B mm	C mm	D mm	E mm
TR0605-WATER	85	70	34	38	50
Dim.	38 mm				



TAPPO RIFORMIMENTO CARBURANTE IN PLASTICA

Code	A mm	B mm	C mm	D mm	E mm
TR0604-FUEL	85	70	34	38	50
Dim.	38 mm				

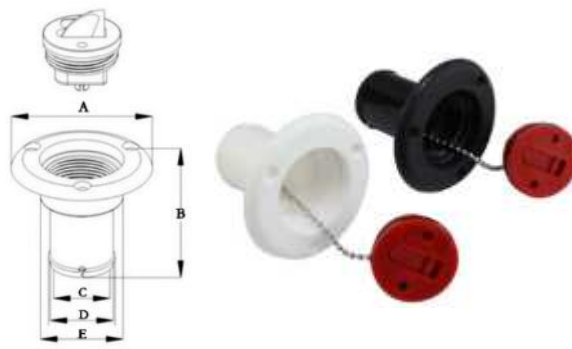

SFIATO CARBURANTE IN PLASTICA

Code	SIZE	A mm	B mm	C mm	D mm	E mm
TR0620-16	5/8 inch	73.5	42	17	23	16
TR0620-20	3/4 inch	80	50.5	19	26.5	18.5
TR0620-25	1 inch	93	61	26	33	25
TR0620-32	1-1/4 inch	97	67	33	41	31.5
TR0620-38	1-1/2 inch	102	75	37	46.5	38
TR0620-50	2 inch	130	90	49	57	51



TAPPO INGRESSO ACQUA IN PLASTICA CON CHIAVE



Cod.	Colore	A (cm)	Materiale
TR2930-W	Bianco	11*11*8	Plastica PP Grado alimentare
TR2930-BK	Nero	11*11*8	Plastica PP Grado alimentare

TAPPO INGRESSO ACQUA PER GRAVITA' CON CHIAVE



Cod.	Colore	A (cm)	Materiale
TR3130-W	Bianco	12*12*9.2	Plastica PP Grado alimentare

TAPPO INGRESSO ACQUA PER GRAVITA' CON CHIAVE



Cod.	Colore	A(cm)	Materiale
TR4060-W	Bianco	11*11*8	Plastic PP Grado alimentare

80 mm (foro a foro), 38 mm (diam. Interno tubo scarico)

TAPPO DI ISPEZIONE IN ABS

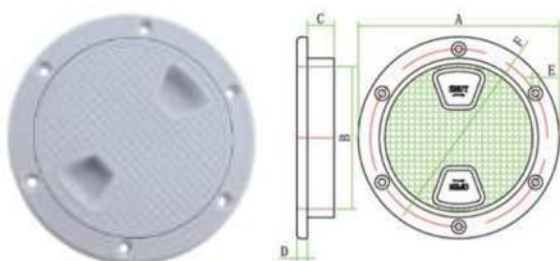

Cod.	Dim.	A	B	C	D	F
TR1301-4	4 inch	143	101	19	7.5	126
TR1301-6	6 inch	198	151	16.5	8.5	179
TR1301-8	8 inch	250	180	19	9.5	230

ALZAPAGLIOLO IN PLASTICA



Cod.	SIZE
TR1302-50 Con chiave	- Materiale: Nylon Plastica - Con serratura e chiave - Colore: Nero - Diametro: 2.4" - Dim. foro: 2" (50mm)
TR1303-50 Senza chiave	- Material: Nylon Plastic - Senza serratura - Colore: Nero - Diametro: 2.4" - Dim. foro: 2" (50mm)

ACCESSORI VARI

AISI316 TAPPO DI ISPEZIONE

Cod.	Dim.	D1 mm	D2 mm
TR3103A	3 inch	123	81.8
TR3104A	4 inch	147	106
TR3105A	5 inch	173	133
TR3106A	6 inch	196.5	161.8



AISI316 TAPPO DI ISPEZIONE

Cod.	Dim.	D1 mm	D2 mm
TR3203B	3 inch	123	81.8
TR3204B	4 inch	147	106
TR3205B	5 inch	173	133
TR3206B	6 inch	196.5	161.8

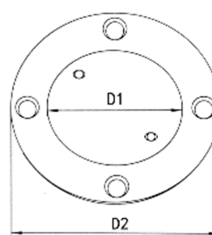

AISI316 CHIUSURA A LEVA

Cod.	L mm	W mm
TR12043A	120	43

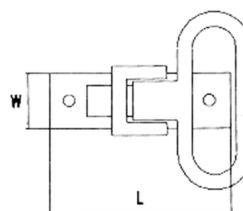

AISI316 CHIUSURA A LEVA

Cod.	A mm	C mm
TR10837B	108	37
TR10845B	108	45
TR14045B	140	45

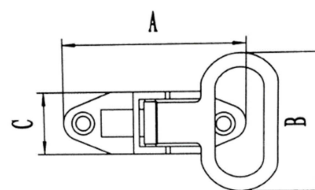

AISI316 GANCI D'ACCOSTO

Cod.	A mm	D mm
TR17034A	170	28
TR19041A	190	34
TR19038B	190	37

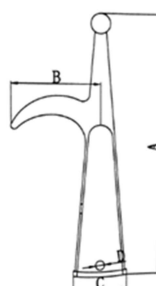

AISI316 TERMINALE CORRIMANO



Cod.	Diametro
TR17034A	22mm
TR19041A	25mm

AISI316 PRESA D'ARIA A FERRITOIA

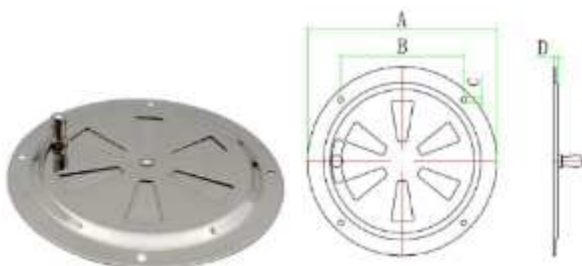

Cod.	Dim.	A mm	B mm	C mm	D mm
TR1702-5	5inch	125	81.5	3.5	3

AISI316 PRESA D'ARIA



Cod.	Dim.	A mm	B mm	C mm	D mm
TR1701-4	4inch	101	65	3.5	5
TR1701-5	5inch	125	81.5	3.5	5.5

AISI316 SCALMO

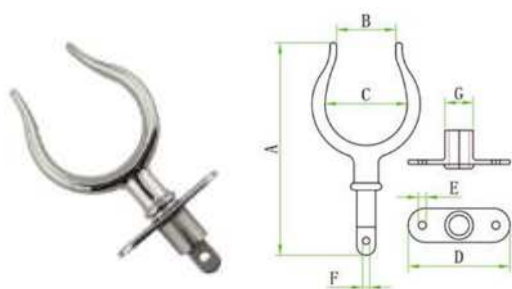

Cod.	A mm	B mm	C mm	D mm	E mm	G mm
TR1501-6	150	35	56	70	5.5	19

AISI316 PONTICELLO

Cod.	A mm	B mm	C mm	D mm	E mm	G mm
TR1602-4	4mm	40	11	1.7	7	32
TR1602-5	5mm	50	13	2.0	9	44
TR1602-6	6mm	58	16	2.5	10	44
TR1602-8	8mm	63	17	3.6	13	47

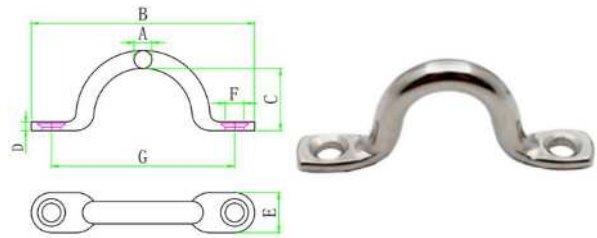

AISI316 PONTICELLO CON BASE

Cod.	Size	A mm	B mm	C mm	D mm	E mm
TR6301-5	5mm	36	60	21	2.5	14
TR6301-6	6mm	40	65	26	2.5	16
TR6301-8	8mm	50	80	32	3	20
TR6301-10	10mm	60	100	38	3	26

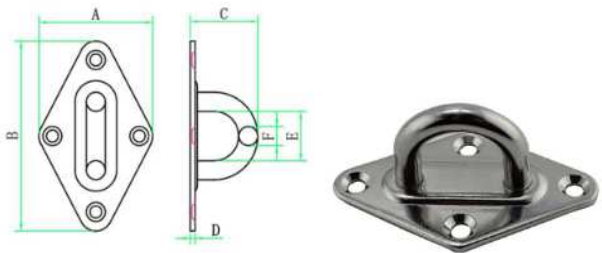

AISI316 PONTICELLO CON BASE

Code	Dim.	A mm	B mm	C mm	D mm	E mm
TR6302-5	5mm	30	35	21	2.5	14
TR6302-6	6mm	35	40	26	2.5	16
TR6302-8	10mm	40	50	32	3	20

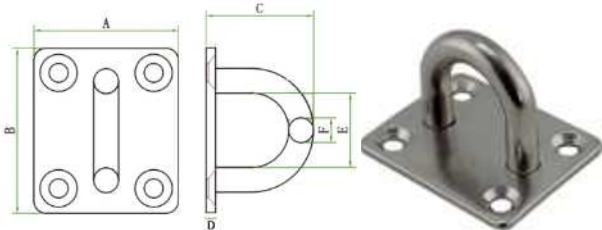

AISI316 PONTICELLO CON BASE

Code	Dim.	A mm	C mm	D mm	E mm	F mm
TR6303-5	5mm	33	21	2.5	14	5
TR6303-6	6mm	40	26	2.5	16	6
TR6303-8	8mm	50	32	3.0	20	8

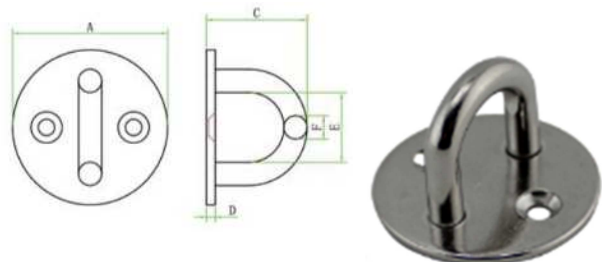

AISI316 PONTICELLO CON BASE

Code	Dim.	A mm	B mm	C mm	D mm	E mm
TR6304-5	5mm	15	45	21	2.5	14
TR6304-6	6mm	20	60	26	2.5	16
TR6304-8	8mm	25	80	32	3.0	20

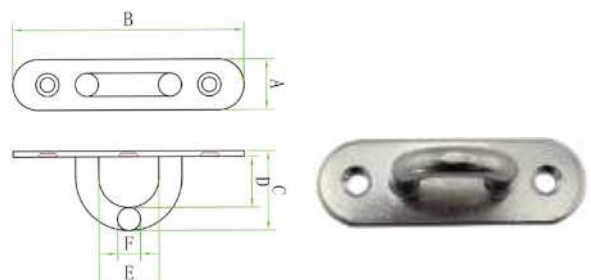

AISI316 ANELLO SNODATO

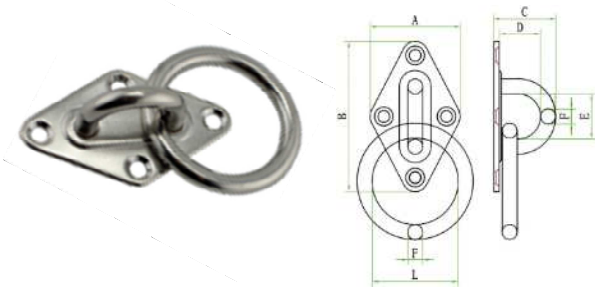

Code	Dim.	A mm	B mm	C mm	D mm	E mm	F mm	L mm
TR6305-5	5mm	36	60	21	2.5	14	5	30
TR6305-6	6mm	40	65	26	2.5	16	6	35
TR6305-8	8mm	50	80	32	3.0	20	8	45
TR6305-10	10mm	60	100	38	3.0	26	10	50

AISI316 ANELLO SNODATO

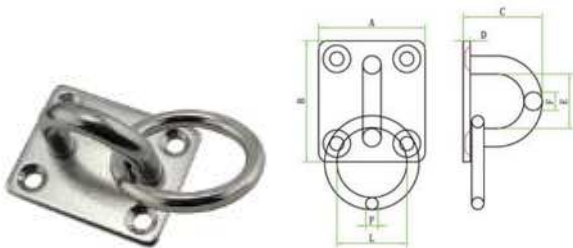

Code	Dim.	A mm	B mm	C mm	D mm	E mm	F mm	L mm
TR6306-5	5mm	30	35	21	2.5	14	5	30
TR6306-6	6mm	35	40	26	2.5	16	6	35
TR6306-8	8mm	40	50	32	3.0	20	8	45

AISI316 ANELLO SNODATO

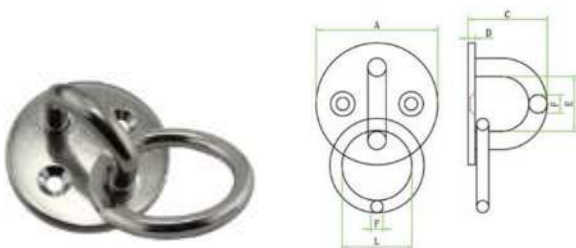

Code	Dim.	A mm	B mm	C mm	D mm	E mm	F mm
TR6307-5	5mm	33	21	2.5	14	5	30
TR6307-6	6mm	40	26	2.5	16	6	35
TR6307-8	8mm	50	32	3.0	20	8	45

AISI316 ANELLO SNODATO

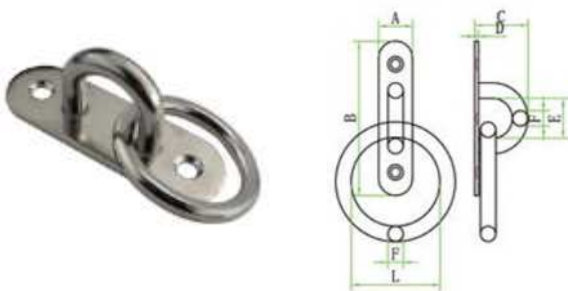

Code	Dim.	A mm	B mm	C mm	D mm	E mm	F mm	L mm
TR6308-5	5mm	15	45	21	2.5	14	5	30
TR6308-6	6mm	20	60	26	2.5	16	6	35
TR6308-8	8mm	25	80	32	3.0	20	8	45

AISI316 GALLOCCIA

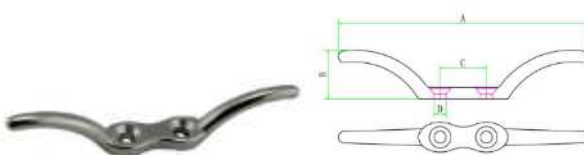

Code	Dim.	A	B	C	D	Peso/kg
TR0204-4	4 inch	112	21	21	5	0.036
TR0204-6	6 inch	151	28	28	7	0.076

AISI316--MOSCHETTONI- GRILLI- GIRELLE

MOSCHETTONI PER VELA

Cod.	Dim.	A	B	C	WLL/kg	WT/kg
TR6401-35	35MM	12.5	7.5	35	100	0.013
TR6401-52	52MM	18	11	52	450	0.043
TR6401-69	69MM	20	15	70	650	0.082
TR6401-96	96MM	27	18.5	96	950	0.212

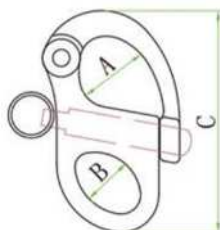

MOSCHETTONI PER VELA

Cod.	Dim.	A	B	C	WLL/kg	WT/kg
TR6402-70	70MM	18	12.5	71	450	0.061
TR6402-87	87MM	20	16.5	89	650	0.115
TR6402-128	128MM	27	24	128	950	0.291

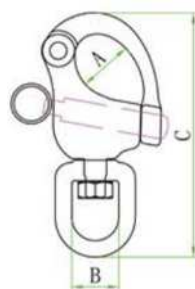

MOSCHETTONI PER VELA

Cod.	Dim.	A	B	C	WLL/kg	WT/kg
TR6403-70	70MM	18	10	70	450	0.067
TR6403-87	87MM	20	12.5	91	650	0.138
TR6403-128	128MM	27	21	128	950	0.342

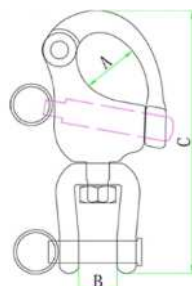

MOSCHETTONI PER VELA

Cod.	Dim.	A	B	C	WLL/kg	WT/kg
TR6404-20	20*65	14	21	65	270	0.041
TR6404-25	25*76	15	26	76	340	0.071

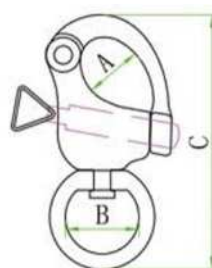

GRILLO CON CHIUSURA A SCATTO

Cod.	Dim.	A	B	C	WLL/kg	WT/kg
TR6406-5	5mm	13	40	5	100	0.029
TR6406-6	6mm	15	42	6	150	0.051
TR6406-8	8mm	21.5	61	8	250	0.111

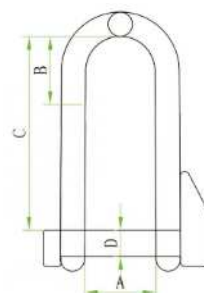

GRILLO CON CHIUSURA A SCATTO

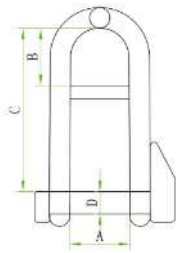

Cod.	Dim.	A	B	C	D	WLL/kg	WT/kg
TR6407-5	5mm	13	12.5	40	5	100	0.035
TR6406-6	6mm	15	15	42	6	150	0.062
TR6406-8	8mm	21.5	26	61	8	250	0.122

GRILLO LUNGO

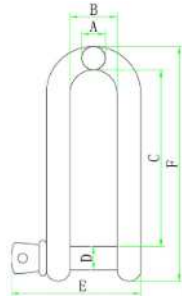

Cod.	Dim.	B	C	D	E	WLL/kg	WT/kg
TR6411-4	4mm	8	30	4	24	70	0.015
TR6411-5	5mm	10	37.5	5	30	140	0.018
TR6411-6	6mm	12	45	6	35	230	0.031
TR6411-8	8mm	16	60	8	43.5	340	0.077
TR6411-10	10mm	20	75	10	56	700	0.157
TR6411-12	12mm	24	90	12	66	1200	0.251

GRILLO

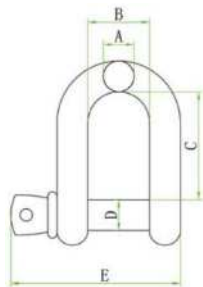

Cod.	Size	B	C	D	E	WLL/kg	WT/kg
TR6409-4	4mm	8	16	4	24	60	0.008
TR6409-5	5mm	10	20	5	30	80	0.016
TR6409-6	6mm	12	24	6	35	100	0.025
TR6409-8	8mm	16	32	8	43.5	200	0.059
TR6409-10	10mm	20	40	10	56	320	0.115
TR6409-12	12mm	24	48	12	66	520	0.198
TR6409-14	14mm	28	56	14	75.5	700	0.306
TR6409-16	16mm	32	64	16	88	800	0.461
TR6409-18	18mm	36	72	18	99.5	950	0.672
TR6409-20	20mm	40	80	20	109	1100	0.875
TR6409-22	22mm	44	90	22	120	1500	1.257
TR6409-24	24mm	50	96	24	135	2100	1.655
TR6409-28	28mm	56	112	28	148	3000	2.496

GRILLO TORTO

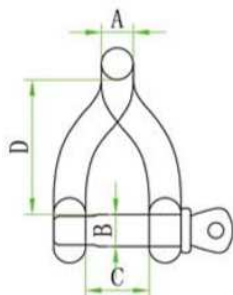

Cod.	Dim.	B	C	D	E	WLL/kg	WT/kg
TR6412-4	4mm	4	4	8	22	99	0.015
TR6412-5	5mm	5	5	10	27.5	120	0.018
TR6412-6	6mm	6	6	12	33	175	0.031
TR6412-8	8mm	8	8	16	44	300	0.077
TR6412-10	10mm	10	10	20	55	580	0.157
TR6412-12	12mm	12	12	24	66	700	0.251

Cod.	Dim.	A	B	C	D	WLL/kg	WT/kg
TR6414-5	3/16" *6	4.8	9.5	22	6	350	0.02
TR6414-6	1/4" *8	6.2	11.5	28.5	7.8	500	0.038
TR6414-8	1/16" *10	8	13	30.5	9	750	0.073
TR6414-10	3/8" *12	9.3	16.5	36.5	11	1000	0.138
TR6414-11	7/16" *14	11	19	42.5	12.5	1500	0.19
TR6414-12	1/2" *16	12.5	20	47.5	15.5	2000	0.31
TR6414-16	5/8" *20	15.8	26.5	60	19	3250	0.62
TR6414-20	3/4" *22	19	31.5	71	22	4750	0.97
TR6414-22	7/8" *24	22	36.5	84	25	6500	1.37
TR6414-25	1" *28	25.2	42.6	95	28	8500	2.08

GRILLO A CETRA

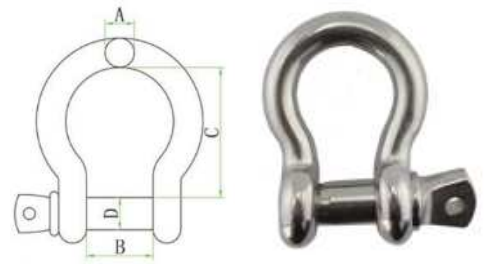

Cod.	Dim.	A	B	C	D	WLL/kg	WT/kg
TR6501-4	4mm	48	11.8	9.8	3.8	80	0.02
TR6501-5	5mm	60	13.8	14.5	4.8	100	0.034
TR6501-6	6mm	68	15.8	16.8	5.5	150	0.048
TR6501-8	8mm	88	20	21	7.4	300	0.111
TR6501-10	10mm	107	23	26	9.3	500	0.202
TR6501-12	12mm	122	25.5	27	11.2	1000	0.325
TR6501-14	14mm	145	31.8	33.2	13	1200	0.518
TR6501-16	16mm	175	38	44	15	1500	0.81
TR6501-20	20mm	203	44	47.8	18.8	2100	1.48

GIRELLE DOPPIO OCCHIO CHIUSE

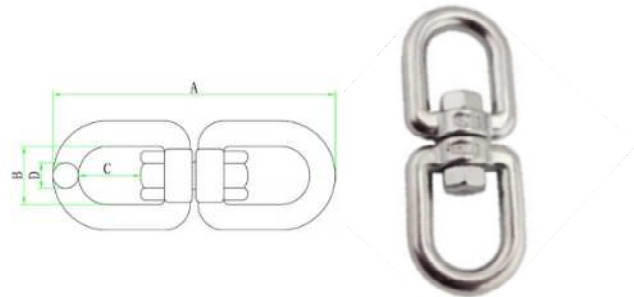

Cod.	Dim.	A	B	C	D	WLL/kg	WT/kg
TR6502-4	4mm	50	11.8	9.8	3.8	80	0.022
TR6502-5	5mm	60	13.8	14.5	4.8	100	0.038
TR6502-6	6mm	66.5	15.8	16.8	5.5	150	0.056
TR6502-8	8mm	88	20	21	7.4	300	0.129
TR6502-10	10mm	106	23	26	9.3	500	0.238
TR6502-12	12mm	124	25.5	27	11.2	1000	0.372
TR6502-14	14mm	145	31.8	33.2	13	1200	0.6
TR6502-16	16mm	179	38	44	15	1500	0.94
TR6502-20	20mm	203	44	47.8	18.8	2100	1.71

GIRELLE CON GRILLO SINGOLO

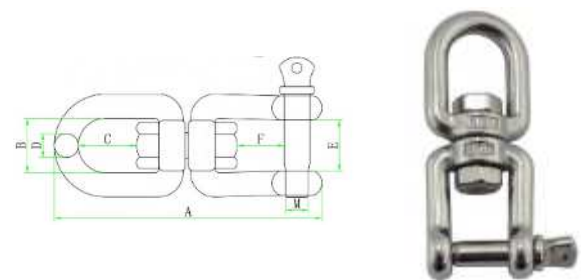

Cod.	Dim.	A	B	C	D	WLL/kg	WT/kg
TR6503-4	4mm	51	8	10.5	3.8	80	0.025
TR6503-5	5mm	60	10	11	4.8	100	0.041
TR6503-6	6mm	66.5	12	11.5	5.8	150	0.062
TR6503-8	8mm	88.5	16	17	7.8	300	0.144
TR6503-10	10mm	106	20	19	9.8	500	0.281
TR6503-12	12mm	124	24	22	11.8	1000	0.438
TR6503-14	14mm	143	28	26	13.8	1200	0.671
TR6503-16	16mm	182	32	38	15.8	1500	1.071
TR6503-20	20mm	205	40	38	19.8	2100	1.828

GIRELLE CON GRILLO DOPPIO

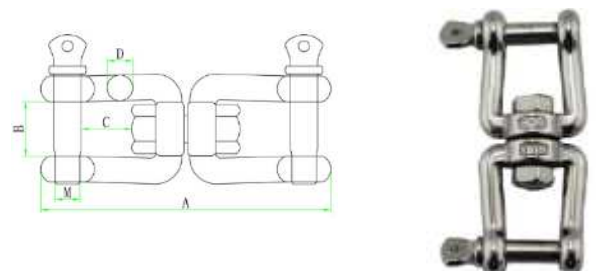

GANCIO GRU GIREVOLE

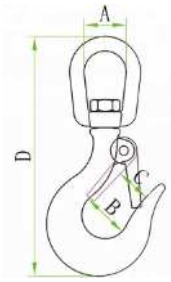

Cod.	Dim.	A	B	C	WLL/kg	WT/kg
TR6102-150	3/16inch	15.8	17.6	11	150	0.082
TR6102-350	1/4inch	22	23.9	16.9	350	0.155
TR6102-650	5/16inch	27	26.7	20.5	650	0.237
TR6102-1000	3/8inch	28.5	32.8	23.5	1000	0.436
TR6102-1500	1/2inch	36	37.8	31	1500	0.711

GANCIO GRU

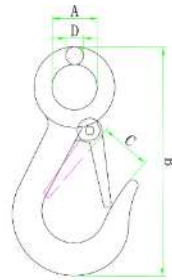

Cod.	Dim.	A	B	C	WLL/kg	WT/kg
TR6101-0.2	0.2T	18	92	18	200	0.091
TR6101-0.3	0.3T	19	102	17	300	0.127
TR6101-0.5	0.5T	28	119	17	500	0.210

GANCIO GRU CON CHIAVISTELLO

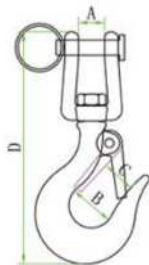

Cod.	Dim.	A	B	C	D	WLL/kg	WT/kg
TR6103-150	3/16' '	9.5	17.6	11	90	150	0.09
TR6103-650	1/4' '	12.5	24	16.9	114	350	0.167
TR6103-650	5/16' '	15	26	20.5	138	650	0.259
TR6103-1000	3/8' '	17.5	32.8	23	158	1000	0.456
TR6103-1500	1/2' '	36	36	31	190	1500	0.748

GANCIO GRU

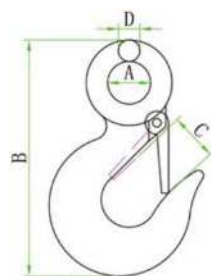

Cod.	Dim.	A	B	C	D	WLL/kg	WT/kg
TR6104-0.5	0.5T	16.5	90	16	8	500	0.144
TR6104-0.75	0.75T	18.5	101.5	18.5	9	750	0.204
TR6104-1	1.0T	23	114.5	21	11	1000	0.286
TR6104-1.5	1.5T	28	129.5	21.5	12	1500	0.418
TR6104-2	2.0T	32	153	26	15	2000	0.656
TR6104-3	3.0T	38	182.5	31.5	17.5	3000	1.257

GANCIO GRU CON SCROCCO

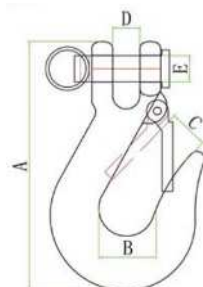

Cod.	Dim.	A	B	C	D	WT/kg
TR6105-0.5	1/4' '	99	22	14.5	11.5	0.218
TR6105-0.5	5/16' '	113.5	25	18.5	12.5	0.328
TR6105-0.5	3/8' '	129.5	28	22	14.5	0.468
TR6105-1.5	1/2' '	155.5	33.5	27	16.5	0.778

GANCIO A MOLLA APERTURA RAPIDA

Cod.	Dim.	A	B	C	D	E	F	WT/kg
TR6109-4	4 "	100	20	10	9	4.5	23	0.09

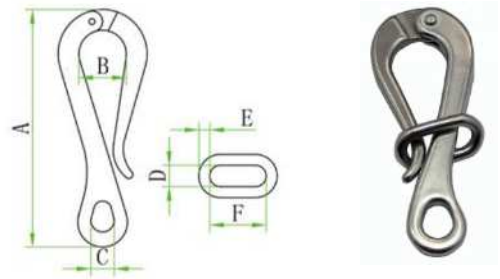

MOSCHETTONE CON GIRELLA

Cod.	Dim.	A	B	C	D	WLL/kg
TR6201-1	1#(3/8' ' *65)	11.5	3.5	9	65	30
TR6201-2	2#(1/2' ' *72)	13.5	4	9.5	72	50
TR6201-3	3#(5/8' ' *82)	17.5	4.5	10	82	100
TR6201-4	4#(3/8' ' *65)	21.5	5	11.5	91	120
TR6201-5	1#(3/8' ' *65)	26.5	5.5	12	100	150
TR6201-6	1#(3/8' ' *65)	34	6	14	126	180

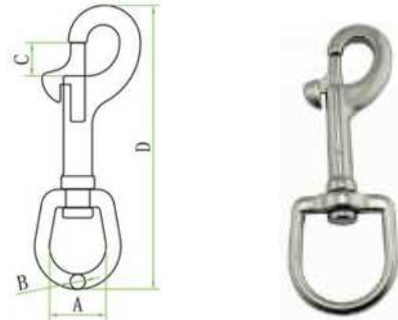

MOSCHETTONE CON GIRELLA

Cod.	Dim.	A	B	C	D	WLL/kg
TR6202-1	1#(1/2' ' *63)	14.5	3.5	9	63	30
TR6202-2	2#(5/8' ' *71)	17.5	4	9.5	71	50
TR6202-3	3#(3/4' ' *81)	22	4.5	10	81	100
TR6202-4	4#(1' ' *90)	26	5	11	90	120
TR6202-5	5#(1-1/8' ' *97)	29	5.5	12	97	150
TR6202-6	6#(1-1/4' ' *119)	34.5	6	14	119	180

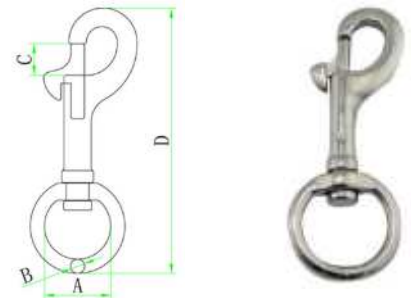

MOSCHETTONE CON GIRELLA

Cod.	Dim.	A	B	C	D	WLL/kg	WT/kg
TR6203-1	1#(5/8' ' *59)	17.5	3.5	9	59	30	0.022
TR6203-2	2#(3/4' ' *66)	23.5	4	9.5	66	50	0.029
TR6203-3	3#(1' ' *73)	25.5	4.5	10	73	100	0.042
TR6203-4	4#(1-1/8' ' *80)	31.5	5	11	80	120	0.049
TR6203-5	5#(1-1/4' ' *85)	36.5	5.5	12	85	150	0.061
TR6203-6	6#(1-1/2' ' *105)	42.5	6	14	105	180	0.099

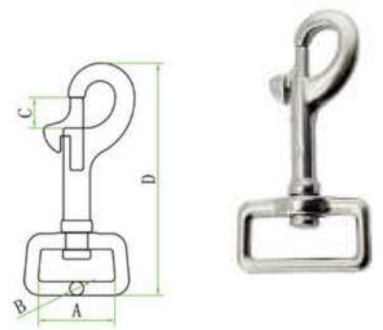

MOSCHETTONE CON GIRELLA

Cod.	Dim.	A	B	C	D	WLL/kg	WT/kg
TR6203-1	1#(5/8' ' *59)	17.5	3.5	9	59	30	0.022
TR6203-2	2#(3/4' ' *66)	23.5	4	9.5	66	50	0.029
TR6203-3	3#(1' ' *73)	25.5	4.5	10	73	100	0.042
TR6203-4	4#(1-1/8' ' *80)	31.5	5	11	80	120	0.049
TR6203-5	5#(1-1/4' ' *85)	36.5	5.5	12	85	150	0.061
TR6203-6	6#(1-1/2' ' *105)	42.5	6	14	105	180	0.099



GANCIO A SCATTO CON GIRELLA

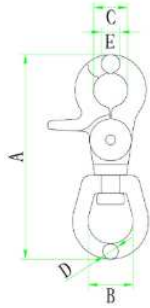

Cod.	Dim.	A	B	C	D	E	WLL/kg	WT/kg
TR6216-12	1/2*65	65	15.5	10.5	4.2	7	90	0.048

AISI 316 MOSCHETTONE

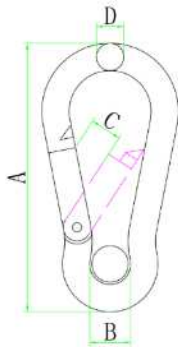

Cod.	Dim.	A	B	C	D	WLL/kg	WT/kg
TR6213-4	4*40	40	5	6	3.8	40	0.009
TR6213-5	5*50	50	6.5	7	4.8	50	0.018
TR6213-6	6*60	60	7.5	8	5.8	70	0.029
TR6213-7	7*70	70	9	8	6.8	100	0.047
TR6213-8	8*80	80	10	9	7.8	125	0.068
TR6213-9	9*90	90	11	10	8.8	140	0.096
TR6213-10	10*100	100	13	12	9.8	200	0.135
TR6213-11	11*120	120	15	16	10.8	250	0.189
TR6213-12	12*140	140	18	19	11.8	300	0.269
TR6213-13	13*160	160	20	25	12.8	350	0.365
TR6213-14	14*180	180	22	35	13.8	450	0.515

AISI316 MOSCHETTONE

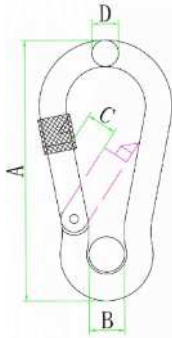

Cod.	Dim.	A	B	C	D	WLL/kg	WT/kg
TR6214-4	4*40	40	5	6	3.8	40	0.009
TR6214-5	5*50	50	6.5	7	4.8	50	0.018
TR6214-6	6*60	60	7.5	8	5.8	70	0.029
TR6214-7	7*70	70	9	8	6.8	100	0.047
TR6214-8	8*80	80	10	9	7.8	125	0.068
TR6214-9	9*90	90	11	10	8.8	140	0.096
TR6214-10	10*100	100	13	12	9.8	200	0.135
TR6214-11	11*120	120	15	16	10.8	250	0.189
TR6214-12	12*140	140	18	19	11.8	300	0.269
TR6214-13	14*180	180	22	35	13.8	450	0.515

PULEGGIA

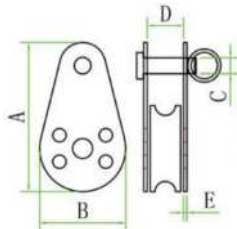

Cod.	Dim.	A	B	C	D	E	WT/kg
TR6606-25	25MM	45	26	5	11	1	0.023

PULEGGIA

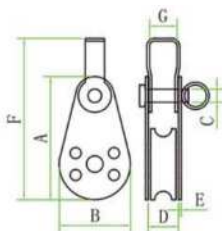

Cod.	Dim.	A	B	C	D	E	WT/kg
TR6607-25	25MM	45	26	5	11	1	0.026

BASI PER ANTENNE

AISI316 BASE A DOPPIO SNODO

Cod.	L mm	W mm	H mm	D mm
TR9364A	93	64	112	25

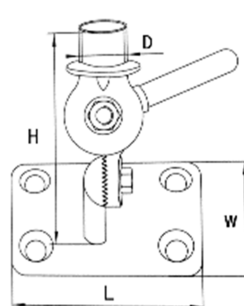

AISI316 BASE A SNODO

Cod.	D mm
TR1220B	22mm



AISI316 BASE A SNODO

Cod.	D mm
TR1250C	25mm



AISI316 BASE SNODATA

Cod.	L mm	W mm
TR8050D	80	50



AISI316 BASE DI SUPPORTO

Cod.	L mm
TR7025E	25



VOLANTI

AISI316/304 VOLANTE



Cod.	Dim.	foro	Incl.
TR0125S	29cm	19mm	25°
TR0126S	34cm	19mm	25°
TR0128S	39cm	19mm	25°

AISI316/304 VOLANTE SPORT LISCIO CON POMELLO



Cod.	Dim.	foro	Incl.
TR0130S	29cm	19cm	25°
TR0132S	34cm	19cm	25°
TR0138S	39cm	19cm	25°

AISI316/304 VOLANTE SPORT SAGOMATO PER DITA CON POMELLO



Cod.	Dim.	foro	Diam.tubo
TR0150S	29cm	19cm	25mm
TR0151S	34cm	19cm	25mm
TR0153S	39cm	19cm	25mm

AISI316/304 VOLANTE CON POMELLO



Cod.	Dim.	foro	Diam.tubo
TR0160S	34cm	19cm	22mm
TR0161S	39cm	19cm	22mm

AISI316/304 VOLANTE



Code	SIZE	raggi	Dish
TR0162S	34cm	9	15°

AISI316/304 VOLANTE A 6 RAGGI CON RIVESTIMENTO PVC

Cod.	Dim.	foro	Incl.
TR0170S	34cm	19cm	25°
TR0171S	39cm	19cm	25°



AISI316/304 VOLANTE A 5 RAGGI CON RIVESTIMENTO IN PVC

Cod.	Dim.	foro	Incl.	colore
TR0221S	29cm	19cm	25°	Nero
TR0225S	34cm	19cm	25°	Nero
TR0227S	39cm	19cm	25°	nero



AISI316/304 VOLANTE A 5 RAGGI CON RIVESTIMENTO IN PVC CON POMELLO

Cod.	Dim.	foro	Incl.	colore
TR04010S	29cm	19cm	25°	nero



AISI/304 VOLANTE A 5 RAGGI CON RIVESTIMENTO IN PVC CON POMELLO

Cod.	Dim.	foro	Incl.	colore
TR04017S	34cm	19cm	25°	Nero
TR04019S	39cm	19cm	25°	nero



POMELLO UNIVERSALE PER VOLANTE

Code	Adattabile a tubo diam.
TR06110S	19mm-25mm
TR06120S	19mm-25mm
TR06130S	19mm-25mm



SCALETTE

AISI316 SCALETTA TELESCOPICA SOTTOPLANCIA



Cod.	gradini	Lungh. aperta	Lungh. chiusa	largh. centrale
TR6010H	2	59cm	34cm	26cm.
TR6011H	3	85cm.	36cm	26cm.
TR6012H	4	115cm	39cm	26cm

AISI316 SCALETTA TELESCOPICA



Cod.	gradini	Lungh. aperta	Lungh. chiusa	largh. centrale
TR6020H	2	84cm	34cm	26cm
TR6021H	3	87cm	37cm	26cm
TR6022H	4	115cm	400cm	26cm

AISI316 SCALETTA TELESCOPICA APERTURA MANUALE



Cod.	gradini	Lungh. aperta	Lungh. chiusa	largh. centrale
TR6030H	3	70cm	30cm	29cm
TR6031H	4	92cm	31cm	28cm

AISI316 SCALETTA TELESCOPICA SOTTO PLANCIA



Cod.	gradini	Lungh. aperta	Lungh. chiusa	largh. centrale
TR6050H	2	59cm	34cm	25cm
TR6051H	3	89cm	37cm	25cm

AISI316 SCALETTA APERTURA A MANO TELESCOPICA

Cod.	gradini	Lungh. aperta	Lungh. chiusa	largh. centrale
TR6010H	2	59cm	34cm	25cm
TR6011H	3	86cm	37cm	25cm



AISI316 SCALETTA DIVER TELESCOPICA

Cod.	gradini	Lungh. aperta	Lungh. chiusa	largh. centrale
TR6020H	3	89cm	39cm	35cm
TR6021H	4	114cm	44cm	35cm



AISI316 SCALETTA DIVER TELESCOPICA

Cod.	gradini	Lungh. aperta	Lungh. chiusa	largh. centrale
TR6050H	3		34cm	35cm
TR6051H	4		34cm	45cm



AISI316 SCALETTA CON SLITTA

Cod.	gradini	Lungh. aperta	Lungh. chiusa	largh. centrale
TR6060H	2	60cm	34cm	25 cm
TR6061H	3	89cm	37cm	25cm
TR6062H	4	114cm	39cm	25cm



AISI316 SCALETTA PIEGHEVOLE FISSAGGIO SU MURATA



Cod.	gradini	Lungh. aperta	Lungh. chiusa	largh. centrale
TR6080H	2+1	60cm	12.6 inch	20cm
TR6081H	2+2	88cm	17.7 inch	23cm
TR6082H	3+2	108cm	28.7inch	23cm
TR6083H	2+3	108cm	23.9 inch	25cm
TR6085H	3+3	131cm	28.7 inch	25cm

AISI316 SCALETTA PIEGHEVOLE CON MANIGLIONI



Cod.	gradini	Lungh. aperta	Lungh. chiusa	largh. centrale
TR6090H	3+2	117cm	93cm	25cm
TR6091H	2+3	130cm	68cm	25cm
TR6092H	3+3	153cm	93cm	25cm

AISI316 SCALETTA REGOLABILE DI PRUA



Cod.	gradini	Lungh. aperta	Lungh. chiusa
TR7010H	3	105cm	29cm

AISI316 SCALETTA TELESCOPICA DA PLANCETTA



Cod.	gradini	Lungh. aperta	Lungh. chiusa	largh. centrale
TR7030H	2+1	85cm	43cm	26cm
TR7031H	2+2	107cm	71cm	35cm

AISI316 SCALETTA TELESCOPICA SOTTO PLANCIA

Cod.	gradini	Lungh. aperta	Lungh. chiusa	largh. centrale
TR7040H	3	89cm	37cm	25cm



AISI316 SCALETTA TELESCOPICA SOTTO PLANCIA

Cod.	gradini	Lungh. aperta	Lungh. chiusa	largh. centrale
TR7050H	4	115	39cm	25cm



AISI316 SCALETTA SOTTOPLANCIA SCORREVOLE

Cod.	gradini	Lungh. aperta	Lungh. chiusa	largh. centrale
TR7060H	3	89cm	39cm	34cm
TR7061H	4	114cm	44cm	34cm



AISI316 SCALETTA TELESCOPICA

Cod.	gradini	Lungh. aperta	Lungh. chiusa	largh. centrale
TR7080H	2	60cm	34cm	25cm
TR7081H	3	89cm	37cm	25cm
TR7082H	4	114cm	39cm	25cm

