

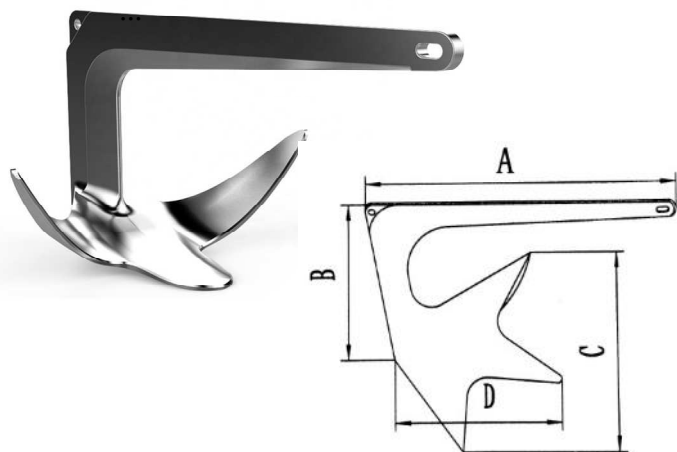

ACCESSORI PER LA NAUTICA

AISI316 ANCORA BRUCE



Cod.	A mm	B mm	C mm	D mm	Peso kg
TR6001	280	102	180	130	1 kg
TR6002	350	127	220	175	2 kg
TR60025	400	150	230	140	2.5KG
TR6003	400	145	250	200	3 kg
TR6005	470	165	310	270	5 kg
TR6075	540	190	350	290	7.5 kg
TR6010	595	210	385	320	10 kg
TR6015	680	255	440	360	15 kg
TR6020	750	300	520	390	20 kg
TR6025	810	310	590	410	25 kg
TR6030	860	320	590	460	30 kg
TR6040	935	370	660	460	40 kg
TR6050	1010	375	700	500	50 kg
TR6080	1050	460	700	547	80 kg

AISI316 ANCORA PLOUGH

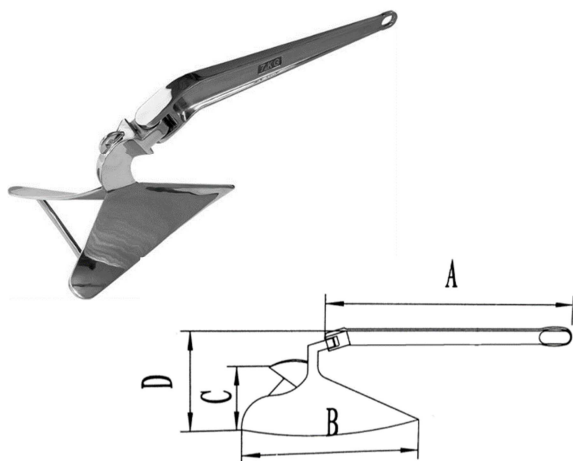

Cod.	A mm	B mm	C mm	D mm	Peso KG
TR6105	510	340	260	220	5 kg
TR6107	560	380	270	230	7 kg
TR6109	600	375	280	250	9 kg
TR6110	620	400	290	270	10 kg
TR6112	660	430	340	300	12 kg
TR6115	730	490	360	330	15 kg
TR6116	735	490	360	240	16 kg
TR6120	740	550	370	360	20 kg
TR6122	750	550	370	390	22 kg
TR6127	780	600	460	360	27 kg
TR6134	800	630	480	360	34 kg
TR6135	820	640	490	380	35 kg

Cod.	A mm	B mm	C mm	Peso kg
TR6204	550	230	210	4 kg
TR6205	555	250	220	5 kg
TR6275	625	300	270	7.5 kg
TR6208	580	290	270	8 kg
TR6210	665	310	300	10 kg
TR6215	755	350	330	15 kg
TR6020	830	370	390	20 kg
TR6230	970	400	450	30 kg
TR6240	1100	430	490	40 kg
TR6250	1170	450	520	50 kg
TR6263	1270	520	565	63 kg
TR6280	1350	600	605	80 kg
TR62100	1500	750	700	100 kg

AISI316 ANCORA DELTA

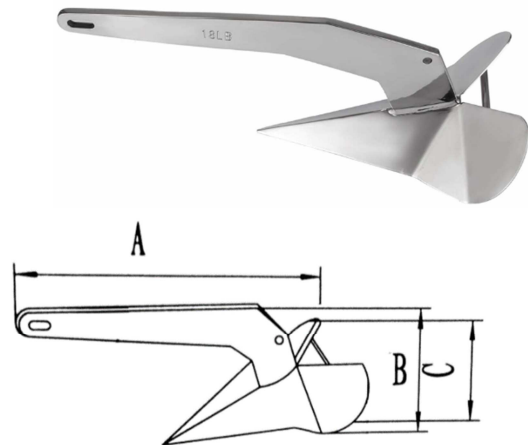

AISI316 ANCORA AD OMBRELLO

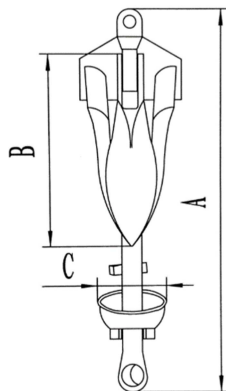

Cod.	A mm	B mm	C mm	Peso kg
TR63007	510	340	260	0.7 kg
TR63015	560	380	270	1.5 kg
TR63025	600	375	280	2.5 kg
TR63032	620	400	290	3.2 kg
TR6304	660	430	340	4 kg
TR6305	730	490	360	5 kg
TR6306	735	490	360	6 kg
TR6307	740	550	370	7 kg
TR6308	750	550	370	8 kg
TR6310	780	600	460	10 kg
TR6312	800	630	480	12 kg

AISI316 ANCORA DANFORTH

Cod.	A mm	B mm	C mm	Peso kg
TR64005	440	650	155	5 kg
TR64075	550	690	160	7.5 kg
TR64010	600	740	190	10 kg
TR64012	650	765	210	12 kg
TR6415	700	880	215	15 kg
TR6420	740	920	230	20 kg
TR6430	830	1050	270	30 kg
TR6440	890	1100	290	40 kg
TR6450	910	1150	300	50 kg
TR6470	1000	1300	320	70 kg
TR64100	1100	1400	350	100 kg

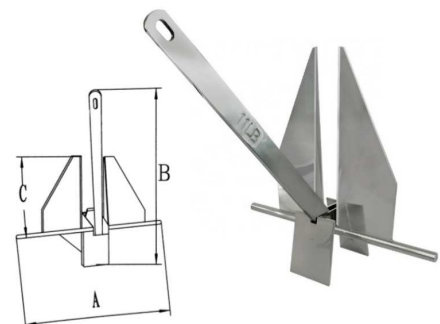

AISI316 ANCORA POOL

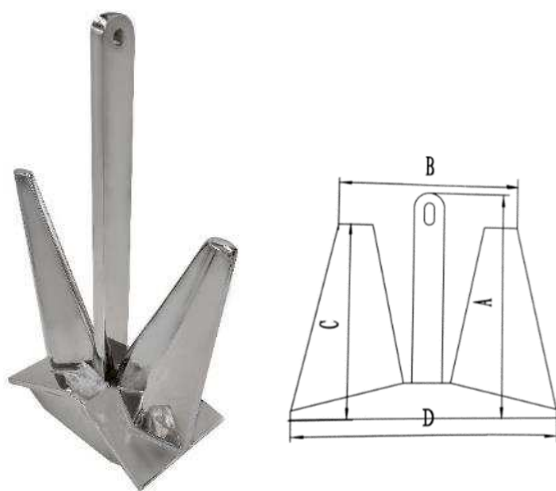

Cod.	A mm	B mm	C mm	D mm	Peso Kg
TR6512	425	315	275	240	12 kg
TR6520	455	385	300	325	20 kg
TR6525	480	410	320	340	25 kg
TR6530	505	430	335	365	30 kg
TR6535	530	460	350	390	35 kg
TR6545	575	490	375	415	45 kg
TR6560	665	555	425	470	60 kg
TR65100	775	655	505	555	100 kg
TR65120	825	700	540	595	120 kg
TR65140	870	735	570	625	140 kg
TR65160	905	765	590	650	160 kg

ANCORA BRUCE GALVANIZZATA



Cod.	Peso kg	Cod.	Peso kg
TR7001	1 kg	TR725	25 kg
TR7002	2 kg	TR730	30 kg
TR7003	3 kg	TR735	35 kg
TR7035	3.5 kg	TR740	40 kg
TR7005	5 kg	TR745	45 kg
TR7075	7.5 kg	TR750	50 kg
TR710	10 kg	TR755	55 kg
TR715	15 kg	TR760	60 kg
TR720	20 kg	TR780	80 kg

ANCORA PLOUGH GALVANIZZATA



Cod.	Peso kg	Cod.	Peso kg
TR7105	5 kg	TR7120	20 kg
TR7107	7 kg	TR7122	22 kg
TR7109	9 kg	TR7124	24 kg
TR7112	12 kg	TR7127	27 kg
TR7115	15 kg	TR7135	35 kg
TR7116	16 kg	TR7140	40 kg

ANCORA DELTA GALVANIZZATA



Cod.	Peso kg	Cod.	Peso kg
TR7204	4 kg	TR7220	20 kg
TR7205	5 kg	TR7225	25 kg
TR7275	7.5 kg	TR7230	30 kg
TR7208	8 kg	TR7232	32 kg
TR7210	10 kg	TR7240	40 kg
TR7216	16 kg	TR7250	50 kg

Cod.	Peso kg	Cod.	Peso kg
TR7302	2 kg	TR7315	15 kg
TR73025	2.5 kg	TR7320	20 kg
TR7303	3 kg	TR7325	25 kg
TR7304	4 kg	TR7330	30 kg
TR7305	5 kg	TR7340	40 kg
TR7306	6 kg	TR7350	50 kg
TR7308	8 kg	TR7370	70 kg
TR7310	10 kg	TR7380	80 kg
TR7312	12 kg	TR73100	100 kg

ANCORA DANFORTH GALVANIZZATA



Cod.	Peso kg	Cod.	Peso kg
TR74015	1.5 kg	TR7410	10 kg
TR74025	2.5 kg	TR7412	12 kg
TR74032	3.2 kg	TR7415	15 kg
TR7404	4 kg	TR7420	20 kg
TR7406	6 kg	TR7425	25 kg
TR7408	8 kg	TR7430	30 kg

ANCORA AD OMBRELLO GALVANIZZATA



ANCORA HALL NERA

Cod.	A (mm)	L (mm)	L1 (mm)	R1 (mm)	B (mm)	B1 (mm)	Peso Nominale (kg)
TR75300	1190	844	595	130	328	388	300 kg
TR75350	1250	890	625	137	344	408	350 kg
TR75400	1310	930	650	143	360	428	400 kg
TR75450	1360	970	675	149	376	444	450 kg
TR75500	1410	1000	700	154	390	460	500 kg
TR75600	1500	1060	745	164	414	490	600 kg
TR75700	1580	1120	785	172	436	516	700 kg
TR75800	1650	1170	820	180	456	540	800 kg
TR75900	1720	1220	855	188	474	560	900 kg
TR751000	1780	1260	885	194	490	580	1000 kg
TR751250	1910	1360	955	109	526	624	1250 kg
TR751500	2030	1450	1015	222	560	664	1500 kg
TR752250	2330	1650	1160	254	642	760	2250 kg
TR752500	2410	1710	1200	263	666	788	2500 kg
TR753000	2560	1820	1275	280	708	836	3000 kg
TR753500	2700	1920	1345	294	746	880	3500 kg
TR754000	2820	2000	1400	308	780	920	4000 kg
TR754500	2940	2080	1455	320	808	956	4500 kg
TR755000	3050	2150	1510	332	836	992	5000 kg



CONNETTORI E GIRELLE PER ANCORE

AISI31 CONNETTORE

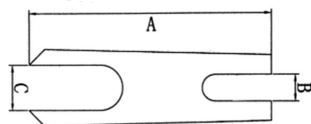

Cod.	A mm	B mm	C mm	Mis. catena
TR801A-0608	91	10.5	15.5	6-8
TR801B-1012	117	13	19	10-12

AISI 316 CONNETTORE DOPPIO

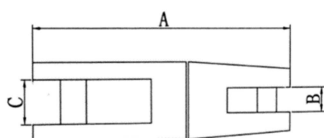

Cod.	A mm	B mm	C mm	Mis. catena
TR802A-0608	90	10.5	15.5	6-8
TR802B-1012	118	13	18	10-12
TR802C-1416	141	18	31	14-16

AISI316 CONNETTORE DOPPIO RINFORZATO

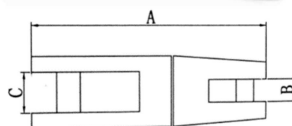
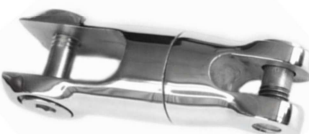

Cod.	A mm	B mm	C mm	Mis. catena
TR803A-0608	90	10.5	15.5	6-8
TR803B-1012	141	18	31	10-12

AISI316 CONNETTORE DOPPIO CON SNODO

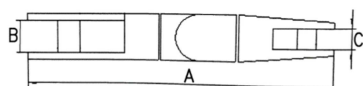
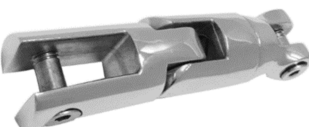

Cod.	A mm	B mm	C mm	Mis. catena
TR804A-0608	120	15	10.5	6-8
TR804B-1012	151	18	13	10-12

AISI316 CONNETTORE



Cod.	A mm	B mm	C mm	Mis. catena
TR805A-0608	230	10	11	6-8
TR805B-1012	305	14	15	10-12

AISI316 MUSONE

Cod.	A mm	B mm	C mm	Catena mm
TR901A	350	65	280	6/8
TR901B	490	70	340	8/10
TR901C	490	80	300	10/12

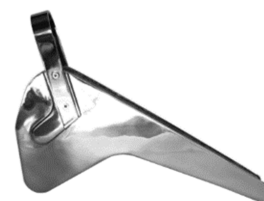
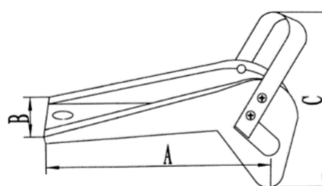

AISI316 MUSONE

Cod.	A mm	B mm	C mm	D mm	E mm
TR902A	165	64	73	54	8

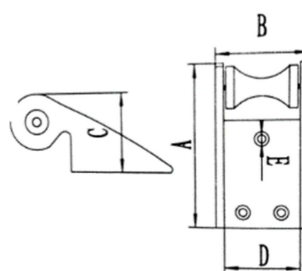

AI316 MUSONE

Cod.	Lungh.mm	Prof. mm	Altezza mm
TR903A	155	51	70



AISI316 MUSONE

Cod.	Lungh mm	Prof. mm	Altezza mm
TR904A	197	62	70



AISI316 MUSONE

Cod.	Lungh.mm	Prof. mm
TR905A	390	46
TR906B	455	87



ISI316 MUSONE

Cod.	Lungh.mm	Prof. mm
TR907A	495	67



CATENE PER ANCORE

DIN766 CATENA A MAGLIA



Cod.	D. mm	L.W.	O.W.	Carico di rottura kn.
TR9103	3	16	11	4.1
TR9104	4	16	13.7	8
TR9105	5	18.5	17	12.5
TR9106	6	18.5	20.2	16
TR9107	7	22	23.8	25
TR9108	8	24	27.2	32
TR9109	9	27	30.6	40
TR91010	10	30	34	50
TR91011	11	31	37.4	63
TR91012	12	34	40.8	66
TR91013	13	36	44.2	80
TR91014	14	41	47.5	100
TR91016	16	45	54.4	125

DIN763 CATENA A MAGLIA



Cod.	D. mm	L.W.	O.W.	Carico di rottura kn
TR9204	4	32	16	6
TR9205	5	35	20	10
TR9206	6	42	24	14
TR9207	7	49	24	18
TR9208	8	52	32	25
TR9209	9	59	36	32
TR9210	10	65	40	40
TR9211	11	72	44	47.5
TR9212	12	78	48	56.5
TR9213	13	82	52	63

DIN5685 MAGLIA CORTA



Cod.	D. mm	L.W.	O.W.	Carico di rottura kn.
TR9304	4	19	16	5
TR9305	5	21	20	7.75
TR9306	6	24	24	11.5
TR9307	7	28	28	15
TR9308	8	32	32	20
TR9309	9	36	36	25
TR9310	10	40	40	31
TR9311	11	44	44	38
TR9312	12	48	48	45

DIN5685 MAGLIA LUNGA



Cod.	D.mm	I.L.	O.W.	Breaking load kn.
TR9404	4	32	16	5.5
TR9405	5	35	20	8.5
TR9406	6	42	24	13.5
TR9407	7	49	28	17
TR9408	8	52	32	23
TR9409	9	59	36	28.5
TR9410	10	65	40	34.5
TR9411	11	72	44	41
TR9412	12	78	48	49
TR9413	13	82	52	53

BITTE E PASSACAVI

AISI316 BITTA SINGOLA

Cod.	A mm	B mm	C mm
TR9401	62	62	81

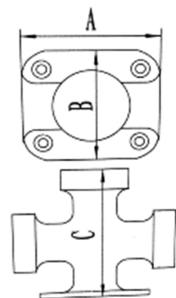

AISI316 BITTA A DOPPIA CROCE

Cod.	A mm	B mm	C mm
TR9402	166	63	88

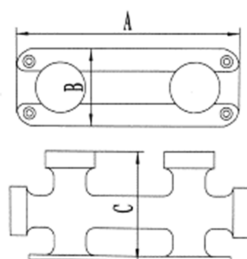

AISI316 BITTA SINGOLA

Cod.	L mm	W mm	H mm
TR9403	85.6	61.8	98



AISI316 BITTA SINGOLA

Cod.	Size	A	B	C	D
TR950A	6''	100	100	42	152
TR950B	8''	135	135	50	190
TR950C	10''	190	150	80	190
TR950D	12''	260	260	80	381

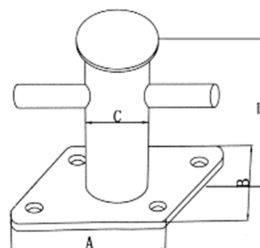

AISI316 BITTA A DOPPIA CROCE

Cod.	Size	A	B	C
TR951A	6''	190	310	130
TR951B	8''	190	370	150
TR951C	10''	260	500	180

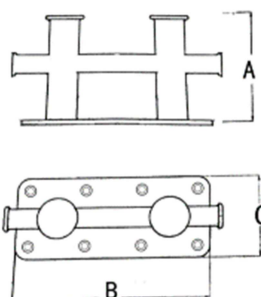

AISI316 BITTA ERCOLE

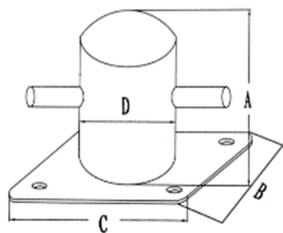

Cod.	A mm	B mm	C mm	D mm
TR952A	120	95	120	62
TR652B	150	120	150	76

AISI316 BITTA A FUNGO

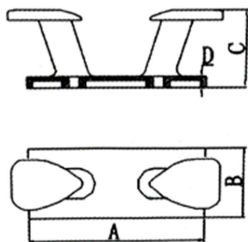

Cod.	Size	A mm	B mm	C mm
TR953A	6' '	152	60	62
TR953B	8' '	203	70	77
TR953C	10' '	255	80	91
TR953D	12' '	310	90	109

AISI316 BITTA

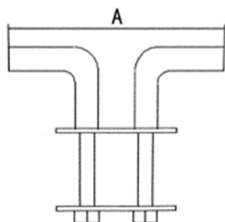

Cod.	A mm
TR954A	295

AISI316 BITTA

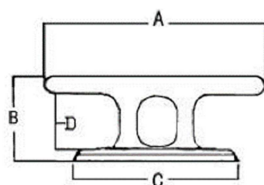

Cod.	Size	A	B	C	D
TR955A	10' '	265	100	200	65
TR955B	12' '	305	120	225	81

AISI316 BITTA

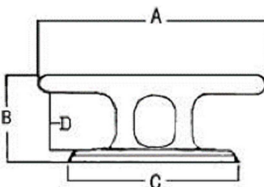

Cod.	A mm	B mm	C mm	D mm
TR956A	302	102	229	70

AISI316 RULLO PASSACAVI

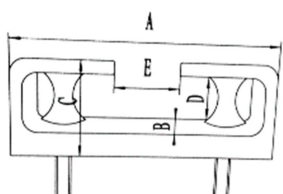

Cod.	A mm	B mm	C mm	D mm	E mm
TR960A	200	41	57	35	43
TR960B	250	45	80	49	44

Cod.	L mm	W mm
TR961	340	160

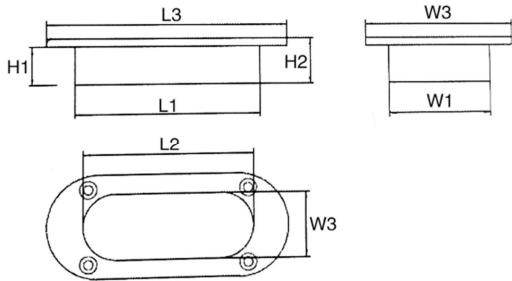

AISI316 RULLO PASSACAVI

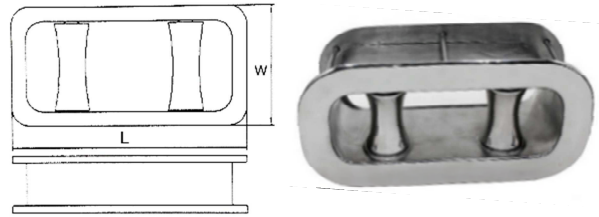

AISI316 PASSACAVO



Cod.	L1 mm	L2 mm	L3 mm	W1 mm	W2 mm	W3 mm	H1 mm	H2 mm
TR962A	103	95	138	47	38	61	23	28
TR962B	188	175	237	88	75	136	24.6	30.6

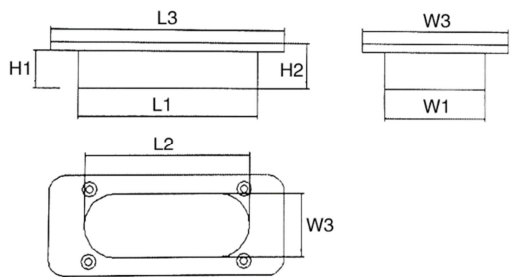

AISI316 PASSACAVO



Cod.	L1 mm	L2 mm	L3 mm	W1 mm	W2 mm	W3 mm	H1 mm	H2 mm
TR963A	128	120	151	58	50	81	30.7	37.2

AISI316 PASSACAVO DI PRUA

Cod.	Pair	A mm	B mm	C mm	D mm
TR964A	Sx	280	80	85	100
	Dx	280	80	85	100

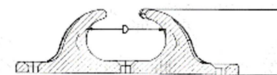
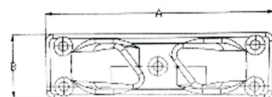

AISI316 PASSACAVO DI PRUA

Cod.	Mis.	A mm	B mm	C mm
TR965A	4inch	100	19	27
TR965B	5 inch	125	21	32
TR965C	6 inch	152	22	32
TR965D	8 inch	203	36	38
TR965E	10inch	254	45	40

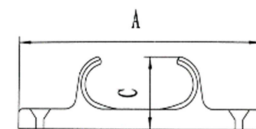

AISI316 PASSACAVO DI PRUA

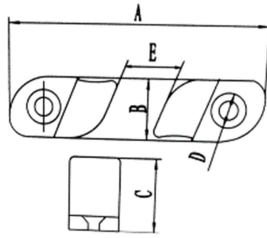

Cod.	Size	A mm	B mm	C mm
TR966A	5inch	125	19	23.5
TR966B	6inch	152	24	26.3

PAIO DX E SX

AISI316 PASSACAVO DI PRUA

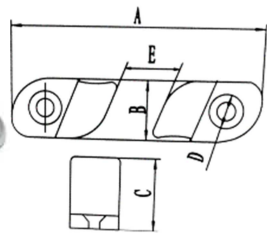

Cod.	Size	A mm	B mm	C mm
TR967A	6inch	152	34	125
TR967B	8inch	205	38	164
TR967C	10inch	254	48	207

PAIO DX E SX

AISI316 PASSACAVO DI PRUA

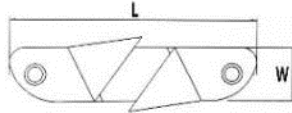

Cod.	Size	L mm	W mm	Vite
TR968A	4-1/2inch	118	22	8
TR968B	6inch	152	35	8

PAIO DX E SX

AISI316 PASSACAVO TRIANGOLARE DI PRUA

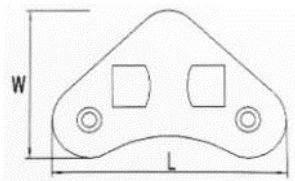

Cod.	L mm	W mm
TR969A	107	65

AISI316 PASSACAVO TRIANGOLARE DI PRUA



Cod.	DIM.
TR970A	63mm*25mm

BITTE

AISI316 BITTA HOLLOW BASE

Cod.	Size	A mm	B mm	C mm
TR1004	4inch	101	36	25
TR1005	5 inch	127	39	30
TR1006	6 inch	150	46	30
TR1008	8 inch	203	53	40
TR1010	10 inch	255	64	45
TR1012	12 inch	305	70	53
TR1015	15 inch	378	78	64

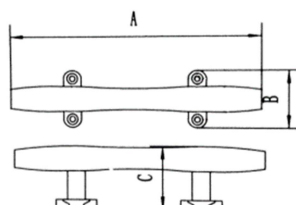

AISI316 BITTA RINFORZATA

Cod.	Size	A mm	B mm	C mm
TR1104	4inch	100	36	27
TR1105	5inch	126	38	29
TR1106	6 inch	152	44	30
TR1108	8 inch	203	54	38
TR1110	10 inch	252	65	44
TR1112	12inch	304	70	53

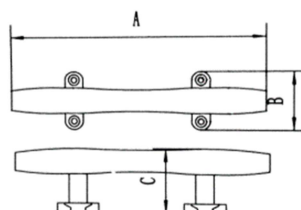

AISI316 BITTA SILHOUETTE

Cod.	Size	A mm	B mm	C mm
TR1204	4inch	100	36	25
TR1205	5inch	125	46	25
TR1206	6inch	152	56	28
TR1208	8inch	201	62	31
TR1210	10inch	252	64	40
TR1212	12inch	302	75	50

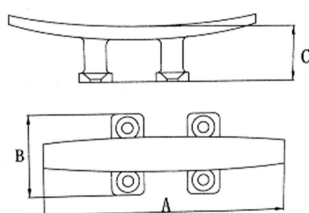

AISI316 BITTA MAST

Cod.	Size	A mm	B mm	C mm
TR1304	4inch	100	13	30.2
TR1305	5inch	125	17	35.5
TR1306	6inch	152	19	39.5
TR1308	8inch	203	23	45.2
TR1310	10inch	252	24	47.6

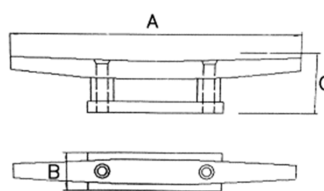

AISI316 BITTA BOMBATA

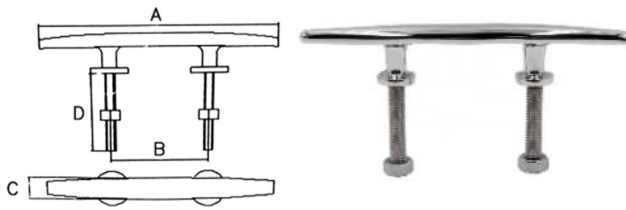

Cod.	Dim.	A mm	B mm	C mm	D mm
TR1406	6inch	150	63	18	45
TR1408	8inch	200	84	22.5	45

AISI316 BITTA BOMBATA

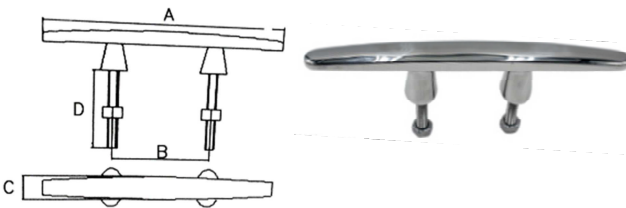

Cod.	Dim.	A mm	B mm	C mm	D mm
TR1506	6inch	150	46.2	15.6	47.3
TR1508	8inch	200	58.2	20	47.3

AISI316 BITTA

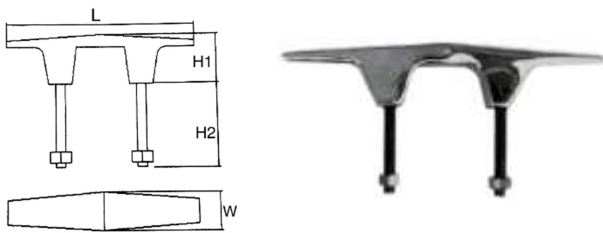

Cod.	L mm	W mm	H1 mm	H2 mm
TR1705	125	26	44	45
TR1706	150	45	56	45

AISI316 BITTA

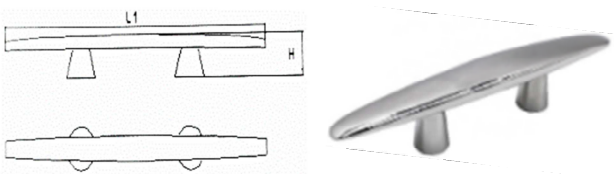

Cod.	Dim.	L1 mm	H mm
TR1908	8inch	205	35
TR1910	10inch	250	45
TR1912	12inch	304	47
TR1915	15inch	385	55

AISI 316 BITTA CAMEL



Cod.	Dim.	L1 mm	H mm
TR	8inch	205	35
TR	10inch	250	45
TR	12inch	304	47
TR	15inch	385	55

AISI316 BITTA A "K" (EAGLE)

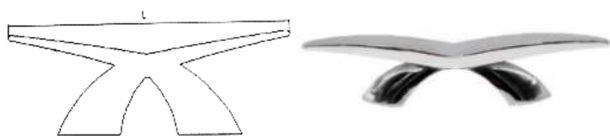

Cod.	L mm	H mm
TR2108A	215	43

AISI316 BITTA CON PASSACAPO

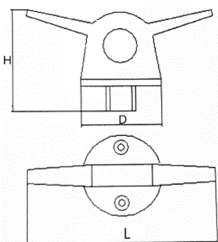

Cod.	L mm	D mm	H mm
TR2201A	175	62	68

AISI316 BITTA

Cod.	L mm	H mm
TR2301A	153	46



AISI316 CORRIMANO

Cod.	L mm	H mm
TR2401A	143	43



AISI316 BITTA ABBATTIBILE

Cod.	Dim.	A mm	B mm
TR2505	5 inch	127	43
TR2506	6 inch	155	52
TR2508	8 inch	203	73

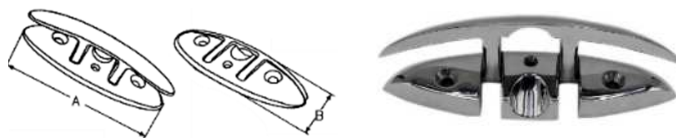

AISI316 BITTA ABBATTIBILE CON VITI

Cod.	L mm	B mm	H mm
TR2605	126	44	110
TR2606	155	54	135
TR2608	210	73	150

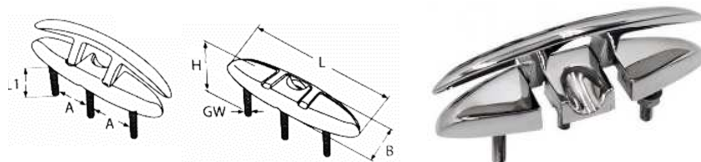

AISI316 BITTA A SCOMPARRSA

Cod.	A mm	B mm	C mm	E mm
TR2705	125	45	23	22
TR2706	160	45	20.5	22

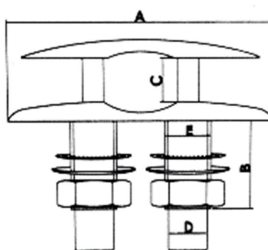

AISI316 BITTA A SCOMPARRSA RINFORZATA

Cod.	A mm	B mm	C mm	E mm
TR2715B	125	42	20	22
TR2716B	152	43	20.5	22

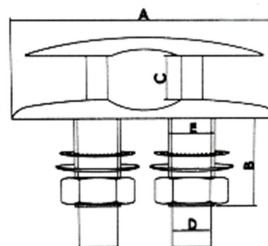

AISI316 BITTA A SCOMPARRSA

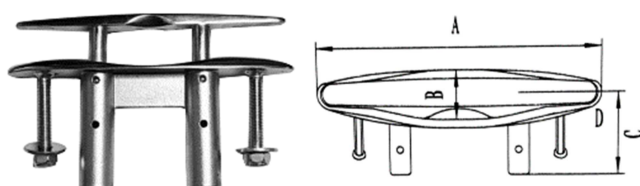

Cod.	Dim.	A mm	B mm	C mm
TR2805	5 inch	130	32	65
TR2806	6 inch	160	35	70
TR2808	8 inch	210	45	96
TR2810	10 inch	260	57	121
TR2812	12 inch	310	69	125

AISI316 BITTA CON ASTA A VITE



Cod.	A mm	B mm
TR2910	260	58
TR2912	300	65

AISI316 BITTA ELEGANCE

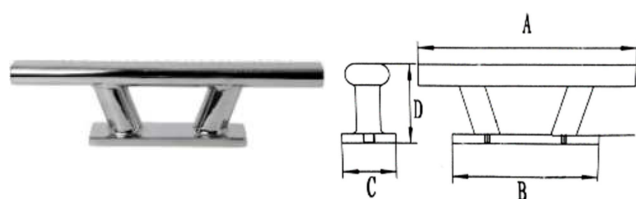

Cod.	Dim.	A	B	C	D
TR3006	6' '	150	118	19	53
TR3008	8' '	215	137	34	56
TR3010	10' '	265	150	40	68
TR3012	12' '	310	175	50	78

AISI316 GALLOCCIA DIVISO CROCIERA (BLOCCA CATENA)



Cod.	L mm	W mm
TR3013	125	84

AISI316 STROZZASCOTTE



Cod.	L mm	W mm
TR3015	69	17
TR3016	81	18

AISI316 BLOCCA CATENA



Cod.	L mm	W mm
TR3017	121	66